

Patch Assembly Instructions

DO NOT SLIDE THE PATCH THROUGH THE SLOTTED TIP.

Please read the enclosed instructions before using this gun cleaning system. Failure to read and follow instructions may cause inadequate results.

1. Insert slotted tip in a slot in the patch
For shotguns only, slide on the patch saver® over the slotted tip.
2. Take a pinch on the patch, pinching upward, slide it through the slot in the tip and pull tight.
Note: The closer you pinch to the slotted tip, the smaller the swab.
*See illustration under **Proper Patch Use** for where to pinch to make the proper size swab.*
3. Tighten the swab by tugging on the top of the patch.

INCORRECT



CORRECT

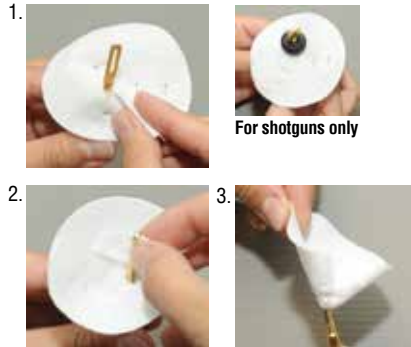

Proper Patch Use

2" Cleaning Patches

- Use for .17 - .25 caliber firearms
- Use small slotted tip

3" Cleaning Patches

- Use for .25 caliber - 12/10 gauge firearms
- Use small slotted tip and outer slots in patch for .25 - .27 caliber firearms
- Use large slotted tip and inner slots in patch for .30 - .50 caliber firearms
- Use shotgun slotted tip and inner slots in patch for shotguns

3" Panoply Cleaning Patches (not pictured) Heavy duty for large bore firearms

- Recommended for .38 caliber/9MM or larger firearms



Bore Obstruction Removal Instructions:

Obstruction remover(s) may be included to assist in removal of stuck cases, mud, snow, and other bore obstructions.

1. Attach the obstruction remover to the end of a Memory-Flex® cable.
2. Insert down the muzzle of the barrel.
3. Tap the obstruction rapidly to loosen.
4. You may need to run a patch to remove any debris the obstruction may have left behind.



Bore Reflector / Flag Safety:

Your cleaning system may include a bore reflector/flag safety. It can be used to illuminate the barrel to check the bore. It also doubles as a flag safety to indicate the firearm is unloaded. Simply insert into the chamber and close the bolt.



Optics Cleaning:

Your cleaning system may contain optics cleaning equipment. Also sold separately (items #240 & #244).

1. Apply lens cleaning solution to lens.
2. Wipe thoroughly and dry with lens cleaning tissues.
Use cotton swabs for hard to reach areas.

For dirty lenses: wash with soap & water and dry with lens cloth.

To remove dust only: brush lens gently with lens brush.



Visit

otistec.com

for instructional videos
and to see our
entire product line

1-800-OTISGUN    

OTIS
SMART GUN CARE

**CLEANING
INSTRUCTIONS**

Bore Cleaning:

Prior to cleaning, be sure the firearm is unloaded.

1. Assemble slotted tip and obstruction remover to Memory-Flex® cable.



2. Create a swab for your firearm. Refer to the **Patch Assembly Instructions** and the **Proper Patch Use** sections on the reverse side.



3. Insert cable, obstruction remover end first, in the chamber and feed out the muzzle. Insert T-handle bar into the obstruction remover. *See Note.*



4. Place a couple drops of solvent on the swab.



5. Pull through from Breech-to-Muzzle®.



6. Remove the patch and slotted tip and replace with a bore brush.



Note: For short actions, you may need to feed the cable from the muzzle to breech and then attach the bore brush, or you can purchase a limited breech brush for .22 caliber (item# FG-321).

7. Insert cable, obstruction remover end first, in the chamber and feed out the muzzle. Insert T-handle bar into the obstruction remover.



8. Pull through from Breech-to-Muzzle®.

9. Remove bore brush and replace with slotted tip.



10. Create a swab for your firearm (using a new cleaning surface). Refer to the **Patch Assembly Instructions** and the **Proper Patch Use** sections on the reverse side.

11. Insert cable, obstruction remover end first, in the chamber and feed out the muzzle. Insert T-handle bar into the obstruction remover.



12. Pull through from Breech-to-Muzzle®.

13. Repeat steps 1-12 as necessary until clean.

Note: For black powder in-line muzzleloaders, be sure to remove the breech plug prior to cleaning.

Note: Your cleaning system may not include a T-handle or obstruction remover. These items also sold separately.

MSR/AR Maintenance Tool Set:

Your cleaning system may contain components from the MSR/AR Maintenance Tool Set. These tools are also great on pistols and in-line muzzleloaders. Also sold separately (item #932).

Can be used to clean the hard to reach areas of your firearm. Suggested uses include:

	Short AP Brush
AR/MSR (modern sporting rifle)	Cleans the locking lugs, bolt, bolt carrier, firing pin & cam pin.
Pistol	Loosens fouling on the extractor, breech face, slide, slide rails, firing pin channel, recoil spring assembly, magazine floor plate & follower.
In-Line Muzzleloader	Loosens fouling from breech plug threads and where breech plug rests.

	Locking Lug Scraper	End Brush	Scrapper
AR/MSR (modern sporting rifle)	Cleans the locking lugs and bolt face.	Lubricates components such as the bolt and bolt carrier.	Cleans the bolt face, bolt, and any other flat areas.
Pistol	_____	Removes fouling from under the extractor, breech face, slide rails, firing pin channel, and outside of the slide. Lubricates the slide rails and barrel.	Removes fouling from under the extractor, breech face, slide rails, firing pin channel, and outside of the slide.
In-Line Muzzleloader	_____	Brushes powder residue from the bolt. Lubricates the breech plug threads.	Removes caked on carbon, gun powder, and grease from previous cleanings.

	Pin Punch	Male Rod/ Female Rod	Straight Pick
	Removes pins on firearms held together by a pin system.	Used to extend the components for added reach.	Removes fouling from any hard to reach area.
	Removes pins on firearms held together by a pin system.	Used to extend the components for added reach.	Removes fouling from any hard to reach area.
	_____	Used to extend the components for added reach.	Removes fouling from any hard to reach area.

BORE BRUSH SIZE SELECTION CHART

RIFLE/PISTOL (8-32 thread) BRUSH SIZE

17HMR, .177 CAL., 4.6MM	.17
204 LIMITED BREECH, 22 RIM-FIRE - SHORT ACTION, LIMITED BREECH, 10-22	.21
204, 22 RIM-FIRE, 219, 22, 222	.22
223, 243, 25-06, 25, 257, 5.56MM, 5.7MM, 6MM, 6.35MM, 6.5MM	.25
270, 280, 284, 6.8MM, 7MM	.27
30, 30-06, 30-30, 303, 308, 300 Win. Mag., 32, 7.62MM, 8MM	.30
338, 340, 35, 357	.35
370, 375, 380, 38 PISTOL, 9MM, 9.3MM	.38
40, 401, 404, 405, 41, 10.75, 10MM	.40
44, 444, 45, 458	.45
50 CAL., 12.9MM	.50

* NOTE: .17 & .21 brushes come with a 5-40 thread

MUZZLELOADER/RIFLE (10-32 thread) BRUSH SIZE

50 CAL.	.50*
54 CAL.	.54
58 CAL.	.58

* NOTE: .50 brush is available with 8-32 thread and 10-32 thread

SHOTGUN (8-32 thread) BRUSH SIZE

.410	410GA
28	28GA
20	20GA
16	16GA
12/10	12GA