

M&P[®]

by **Smith & Wesson[®]**

Safety & Instruction Manual for the M&P[®]12 Pump-Action Shotgun



M&P[®] 12



**Read the instructions and
warnings in this manual
CAREFULLY BEFORE
using this firearm.**

2100 Roosevelt Avenue • Springfield, MA 01104
1-800-331-0852 • Fax: 1-413-747-3317
www.smith-wesson.com

Copyright © 2020 Smith & Wesson Inc.
All rights reserved.



**WARNING:
READ THESE**



INSTRUCTIONS AND WARNINGS CAREFULLY. BE SURE YOU UNDERSTAND THESE INSTRUCTIONS AND WARNINGS BEFORE USING THIS FIREARM. FAILURE TO READ THESE INSTRUCTIONS AND TO FOLLOW THESE WARNINGS MAY RESULT IN SERIOUS INJURY OR DEATH TO YOU AND OTHERS AND DAMAGE TO PROPERTY.

THIS SAFETY & INSTRUCTION MANUAL SHOULD ALWAYS ACCOMPANY THIS FIREARM AND BE TRANSFERRED WITH IT UPON CHANGE OF OWNERSHIP OR WHEN PRESENTED TO ANOTHER PERSON. A COPY OF THE SAFETY & INSTRUCTION MANUAL IS AVAILABLE FREE VIA DOWNLOAD AT WWW.SMITH-WESSON.COM OR UPON REQUEST FROM:

**SMITH & WESSON®
CUSTOMER SUPPORT CENTER
2100 ROOSEVELT AVENUE
SPRINGFIELD, MA 01104
TEL.: 1-800-331-0852, ext. 4125
E-mail: qa@smith-wesson.com**

TABLE OF CONTENTS

YOUR SAFETY RESPONSIBILITIES	3-7
SAFE STORAGE AND TRANSPORTATION	7-9
AMMUNITION	9-11
MODEL AND FEATURES IDENTIFICATION	12
INSPECTING YOUR M&P®12	13-15
PREPARATION FOR FIRING	15-16
LOADING	16-19
TACTILE LOADED CHAMBER INDICATOR	19
FIRING.....	20-21
CLEARING A MISFIRE	21-22
CLEARING A JAM.....	22-23
UNLOADING	24
DISASSEMBLY / FIELD STRIPPING	25-28
REASSEMBLY	28-31
INSTALLATION OF SIGHTS AND OPTICS.....	32
REMOVABLE CHOKE TUBES.....	33-34
SLING SWIVEL INFORMATION	35
INTERCHANGEABLE PALMSWELL GRIP ADAPTERS.....	36-37
CLEANING AND MAINTENANCE	38-40
LIMITED WARRANTY	41-42
CONTACT AND SHIPPING INFORMATION	43-44
BATTERY WARNINGS.....	45
USING THE STORAGE LOCK.....	46-47
PATENT INFORMATION	48

YOUR SAFETY RESPONSIBILITIES

SAFETY IS YOUR NUMBER ONE RESPONSIBILITY!

- At home, in the field, at the range, or anywhere, the first concern of every firearm owner should be safety. Apply the following safety rules in every situation, with any kind of firearm. If you feel uncertain about any operational aspects of your firearm, please contact Smith & Wesson at 1-800-331-0852, ext. 4125 before proceeding with its operation.
- If you are unfamiliar with firearms you should seek formal training before using your shotgun.



WARNING: YOU MUST FOLLOW ALL OF THESE SAFETY RULES TO ENSURE THE SAFE USE OF YOUR FIREARM. THE FAILURE TO FOLLOW THE INSTRUCTIONS AND WARNINGS IN THIS MANUAL COULD CAUSE SERIOUS PERSONAL INJURY OR DEATH TO YOU OR OTHERS AND DAMAGE TO PROPERTY.

- As a firearm owner, you accept a demanding responsibility. How seriously you take this responsibility can be the difference between life and death. There is no excuse for careless or abusive handling of your firearm. At all times handle your firearm with intense respect for its power and potential danger.

YOUR SAFETY RESPONSIBILITIES CONTINUED

- **ALWAYS KEEP YOUR FIREARM POINTED IN A SAFE DIRECTION.** Never point a firearm at anyone or anything you do not intend to shoot whether or not it is loaded. This is particularly important when loading, unloading, or field stripping the firearm. ALWAYS control the muzzle direction of the firearm.
- **ALWAYS KEEP YOUR HANDS BEHIND THE MUZZLE.** Due to the short bullpup design of this shotgun, special care must be taken to never discharge the firearm with any part of the body extended past the muzzle. We strongly recommend only discharging the shotgun when both hands are on the firearm grips. Care should be taken during rapid pumping and firing to prevent your non-trigger hand from slipping off the grip and out in front of the muzzle.
- **ALWAYS KEEP YOUR HANDS AND OTHER BODY PARTS AWAY FROM POSSIBLE PINCH POINTS THAT EXIST IN OPERATING THE SLIDE OF THE M&P®12 SHOTGUN.** The reciprocating action has the potential to pinch body parts and care should be taken to avoid being pinched.
- **ALWAYS TREAT EVERY FIREARM AS IF IT IS LOADED AND WILL FIRE.** Do not take anyone's word that the firearm is unloaded – always check for yourself. Never pass your firearm to another person until the cylinder or action is open and you visually check that it is unloaded. Keep your firearm unloaded and safely stored when not in use.
- **NEVER PLACE YOUR FINGER INSIDE THE TRIGGER GUARD OR ON THE TRIGGER UNLESS YOU INTEND TO FIRE.** Ensure that other objects do not touch the trigger as well.
- **ALWAYS BE SURE OF YOUR TARGET AND WHAT IS BEYOND IT.** Always be sure of where the projectile(s) will strike and shoot only where there is a safe back stop free of obstructions, water or other surfaces which can cause a ricochet. Be sure your projectile(s) will stop behind your target. Projectile(s) can glance off many surfaces like rocks or the surface of water and travel in unpredictable directions with considerable velocity. Do not fire randomly into the sky.
- **NEVER CROSS OBSTACLES SUCH AS FENCES OR STREAMS WITH A LOADED FIREARM.** Always make certain your firearm is unloaded before crossing a fence, climbing a tree, jumping a ditch or negotiating other obstacles.
- **SAFE FIREARM HANDLING IS YOUR PERSONAL RESPONSIBILITY AT ALL TIMES.** Firearms are dangerous and can cause serious injury or death if they are misused or used inappropriately. Safety must be the prime consideration of any one who owns or handles firearms. Accidents are the result of violating the rules of safe firearm handling and common sense. Firearm safety training is available. Contact your firearms dealer, law enforcement agency, local sportsman's club, etc. for availability.

YOUR SAFETY RESPONSIBILITIES CONTINUED

- **YOU ARE RESPONSIBLE FOR THE FIREARM AT ALL TIMES.** In owning a firearm, you must undertake full-time responsibility for your firearm's safety and security. You must protect yourself and all others against injury or death from misuse of the firearm 24 hours a day.
- **FIREARM SECURITY IS YOUR RESPONSIBILITY.** You must secure firearms safely from children and/or unauthorized users. Your firearm should always be kept unloaded and locked when not in use. A lock has been provided for this purpose. Never assume that the use of this lock is sufficient to safely secure your firearm. You must always evaluate your personal situation and employ the security systems that meet your needs and prevent children and unauthorized users from gaining access to your firearm.
- **APPROPRIATE USE FOR YOUR FIREARM MEANS USING YOUR FIREARM FOR LEGAL PURPOSES.** For example - target shooting, hunting and lawful resistance of deadly criminal force. It is your responsibility to ensure that you are in compliance with all applicable regulations, laws and ordinances regarding the use, transport, and storage of your firearm.
- **NEVER RELY ON MECHANICAL FEATURES ALONE.** Only your safe firearm-handling habits will ensure the safe use of your firearm. This is your responsibility.
- **ALWAYS SAFELY STORE AND SECURE YOUR FIREARM.** Safe and secure storage of your firearm is one of your most important responsibilities. It is a full-time responsibility. You must always secure your firearm and ammunition separately so that they are not accessible to children and/or other unauthorized persons.
- **NEVER KEEP AMMUNITION IN THE SAME LOCATION AS THE FIREARM.** Store each in a separate and secure place.
- **ALWAYS WEAR EYE PROTECTION THAT IS SPECIFIED FOR USE WITH FIREARMS** every time you handle your firearm for cleaning and maintenance.
- **ALWAYS WEAR EYE AND HEARING PROTECTION THAT ARE SPECIFIED FOR USE WITH FIREARMS** every time you discharge your firearm. Make sure others in the vicinity of where you will be shooting do so as well.
- **NEVER USE ALCOHOL OR DRUGS BEFORE OR WHILE SHOOTING.** Do not use your firearm if you are on any medication which impairs, even slightly, your mental or physical ability.

YOUR SAFETY RESPONSIBILITIES CONTINUED

- **ALWAYS HAVE ADEQUATE VENTILATION.** Discharging firearms in poorly ventilated areas, cleaning firearms, or handling ammunition may result in exposure to lead and other substances known to cause birth defects, reproductive harm, and other serious physical injury. Review the warnings and labels for all ammunition and cleaning products carefully. Wash hands thoroughly after exposure.
- **BEFORE HANDLING ANY FIREARM, UNDERSTAND ITS OPERATION.** Not all firearms are the same. Familiarize yourself with the mechanical features of any firearm you intend to use. If you feel uncertain about any operational aspects of your firearm, please contact Smith & Wesson at 1-800-331-0852, ext. 4125 before proceeding with its operation.
- **NEVER ALLOW A FIREARM TO BE USED BY INDIVIDUALS WHO DO NOT UNDERSTAND ITS SAFE OPERATION OR HAVE NOT READ THESE FIREARM SAFETY RULES.**
- **ALWAYS USE THE CORRECT AMMUNITION FOR YOUR PARTICULAR FIREARM** as indicated by the marking on the firearm. Never use non-standard, reloaded, or “handloaded” ammunition which has not been subjected to internal ballistic pressure testing.
- **BEWARE OF BARREL OBSTRUCTIONS** Be sure the barrel is clear of obstructions before shooting. Mud, water, snow or other objects may inadvertently lodge in the barrel bore. A small obstruction can cause a dangerous increase in pressure and may damage your firearm and cause injury to yourself and others.
- **BE SURE ALL ACCESSORIES, SUCH AS HOLSTERS, GRIPS, SLINGS, SCOPES AND OTHER ACCESSORIES ARE COMPATIBLE** with the firearm and that the accessories do not interfere with safe operation. It is your responsibility to understand and follow all of the instructions in this manual, as well as those which may be supplied with your ammunition and any accessory.
- **NEVER DISASSEMBLE YOUR FIREARM** beyond the field stripping procedure outlined in this manual. Improper disassembly or reassembly of your firearm may be dangerous and can lead to serious injury or death.
- **NEVER MANIPULATE, ADJUST OR CHANGE ANY OF THE INTERNAL COMPONENTS OF YOUR FIREARM UNLESS SPECIFICALLY INSTRUCTED TO DO SO IN THIS MANUAL.** Improper manipulation of any other internal component may affect the safety and reliability of your firearm and may cause serious injury or death.

YOUR SAFETY RESPONSIBILITIES CONTINUED

- **NEVER ALLOW ANY ALTERATION OR REPLACEMENT OF PARTS IN YOUR SMITH & WESSON FIREARM UNLESS PERFORMED BY A QUALIFIED GUNSMITH** using genuine Smith & Wesson parts. If you do otherwise, improper functioning of your firearm may occur and serious injury or death and damage to property may result.



WARNING: SAFE USE OF A FIREARM IS YOUR PERSONAL RESPONSIBILITY AND THE FAILURE TO FOLLOW ALL OF THESE BASIC SAFETY RULES MAY RESULT IN SEVERE PERSONAL INJURY OR DEATH TO YOU OR OTHERS AND DAMAGE TO PROPERTY. YOU ARE THE MOST IMPORTANT SAFETY DEVICE WHEN IT COMES TO THE USE OF YOUR FIREARM AND SMITH & WESSON WILL NOT BE RESPONSIBLE FOR ANY PERSONAL INJURY, DEATH OR PROPERTY DAMAGE THAT RESULTS FROM: (1) THE CRIMINAL OR NEGLIGENT USE OF THIS FIREARM; (2) A DISREGARD OF THESE SAFETY INSTRUCTIONS AND WARNINGS; (3) IMPROPER OR CARELESS HANDLING OF THIS FIREARM; (4) THE USE OF NON-STANDARD, DEFECTIVE, OR IMPROPER AMMUNITION; OR, (5) IMPROPER OR NEGLIGENT MODIFICATIONS OR REPAIRS TO THE FIREARM.

SAFE STORAGE AND TRANSPORTATION



WARNING: ALWAYS KEEP THE MUZZLE POINTED IN A SAFE DIRECTION.



WARNING: FIREARMS ARE DANGEROUS WHEN USED AND STORED IMPROPERLY. THEY POSE A RISK OF SERIOUS OR FATAL INJURIES. FIREARMS CAN BE ESPECIALLY DANGEROUS TO CHILDREN WHEN THEY ARE STORED IN AN IRRESPONSIBLE AND UNSAFE MANNER. FOR YOUR SAFETY AND THE SAFETY OF OTHERS, IT IS IMPERATIVE THAT YOU KEEP YOUR FIREARM LOCKED AND UNLOADED IN A SECURE PLACE. THE AMMUNITION SHOULD BE STORED IN A SEPARATE, SECURE LOCATION WHEN IT IS NOT IN USE. SAFE AND SECURE STORAGE OF YOUR FIREARM IS ONE OF THE MOST IMPORTANT RULES OF FIREARM SAFETY. YOUR FAILURE TO FOLLOW THESE RULES MAY RESULT IN SERIOUS INJURY OR DEATH TO YOU OR OTHERS.

- **ALWAYS SECURE YOUR FIREARM IN A MANNER THAT WILL PREVENT UNAUTHORIZED ACCESS.** Whenever your firearm is not in use, keep it unloaded and locked. Your safety and the safety of others requires that you always secure and store your firearm in a manner that will prevent unauthorized access. Never leave a firearm unattended unless it is locked, unloaded and secured. Refer to the section of this manual that details USING THE STORAGE LOCK for more information.

SAFE STORAGE AND TRANSPORTATION CONT'D

- **ALWAYS USE THE LOCK PROVIDED BY SMITH & WESSON TO SECURE YOUR FIREARM.** Please read and follow the instructions packaged separately for the use of this lock. A lock, when properly used, can be an effective tool in preventing unauthorized access to your firearm. There are other alternative locks and safe storage containers available in the marketplace which may also be appropriate for your particular needs. Consult your local firearm shop, hardware store, or local police department for guidance on the variety of other safe storage devices or practices which may be appropriate for your particular needs. By purchasing this firearm you have accepted the responsibility of safely securing the firearm at all times and preventing its unauthorized use. Never assume that the use of this lock alone is sufficient to safely secure your firearm. It is your personal responsibility to select and use whatever measures or practices that will enable you to be absolutely certain that your firearm is secure at all times.



WARNING: NEVER LOCK A LOADED FIREARM AND NEVER LOAD A LOCKED FIREARM.

- **ALWAYS STORE YOUR FIREARM AND AMMUNITION SEPARATELY** so that they are not accessible to children or other unauthorized persons. Safe and secure storage of your firearm and ammunition are your responsibility. It is a full-time responsibility.
- **NEVER ASSUME THAT A “HIDING” PLACE IS A SECURE STORAGE METHOD.** Others may be aware of your storage location or come upon it by chance. It is your personal responsibility to use common sense when storing your firearm and ammunition and to always make sure they are not accessible to children or other unauthorized persons.
- **NEVER TRANSPORT A LOADED FIREARM.** When transporting your firearm, be sure it is unloaded and locked. Safe and secure transportation of your firearm is your responsibility.
- **ALWAYS FOLLOW THE LAW!** Many jurisdictions have laws that make it a crime to keep a firearm unlocked and in an area accessible to children or others. Keeping a firearm locked and unloaded when not in use is not only common sense safety practice... IT IS THE LAW.

You must be familiar with all local, state, and federal laws regarding the safe storage and transportation of your firearm. Failure to know and follow the law may result in unauthorized access or use of your firearm by another. Obey all laws relating to the storage and transportation of firearms. Your local police department or firearm shop can furnish you with available information on storing and/or transporting a firearm safely and legally.

SAFE STORAGE AND TRANSPORTATION CONT'D

- **YOUR FIREARM IS YOUR RESPONSIBILITY.** You must prevent your firearm from being stolen or from being used by untrained or unqualified individuals. Keep it locked, unloaded and secured when not in use.
- Never leave the key with the stored firearm.

AMMUNITION

WARNING: NEVER USE AMMUNITION NOT SPECIFICALLY DESIGNATED FOR USE IN YOUR FIREARM. FAILURE TO USE THE CORRECT TYPE OR CALIBER/GAUGE OF AMMUNITION MAY CAUSE THE FIREARM TO JAM, FAIL TO FIRE, OR MAY GENERATE EXCESSIVE PRESSURE WHICH CAN DAMAGE OR EVEN RUPTURE YOUR FIREARM, CAUSING PERSONAL INJURY OR DEATH TO THE SHOOTER OR BYSTANDERS.

- Locate the shotshell designation marked on the firearm. This information indicates the correct ammunition type that must be used in your firearm (FIGURE 1).
- You are responsible for selecting ammunition that meets industry standards and is appropriate in type and caliber for this firearm.

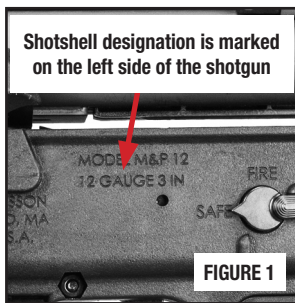

WARNING: NEVER MIX AMMUNITION. A SMALLER GAUGE SHELL MAY LODGE IN THE BORE. A CORRECT GAUGE SHELL FIRED BEHIND IT COULD RESULT IN PERSONAL INJURY OR DEATH TO THE SHOOTER OR BYSTANDERS AND DAMAGE TO THE FIREARM.

- The M&P®12 shotgun is chambered for 12 Gauge 3 inch shells.
- Magazine capacity: 12 Gauge 3 inch shells: Up to six (6) shells in each magazine tube.
- While the M&P®12 Shotgun is chambered for 3 inch shells, it can also fire 2 3/4 inch shells and shorter-length shells in 12 Gauge. Smith & Wesson recommends that you thoroughly test the ammunition you intend to use in your M&P®12 shotgun for chambering and ejection reliability.

WARNING: NEVER USE AMMUNITION OF THE INCORRECT GAUGE OR CALIBER. USING AMMUNITION OF THE INCORRECT GAUGE OR CALIBER MAY CAUSE DAMAGE TO YOUR FIREARM AND SERIOUS INJURY TO YOU AND TO OTHERS.

AMMUNITION CONTINUED



WARNING: IN SOME CASES, A ROUND OF AMMUNITION NOT SPECIFIED ON YOUR FIREARM AND NOT LISTED AS ALTERNATE AMMUNITION IN THIS MANUAL, MAY FIT INTO THE CHAMBER. FIRING THIS AMMUNITION MAY CAUSE A RUPTURE RESULTING IN DAMAGE TO THE FIREARM AND PERSONAL INJURY OR DEATH TO THE SHOOTER OR BYSTANDERS. FOR MORE INFORMATION REGARDING UNSAFE CALIBER COMBINATIONS, REFER TO THE FOLLOWING URL: [HTTPS://SAAMI.ORG/TECHNICAL-INFORMATION/UNSAFE-FIREARM-AMMUNITION-COMBINATIONS/](https://saami.org/technical-information/unsafe-firearm-ammunition-combinations/)



WARNING: ALWAYS INSPECT YOUR AMMUNITION BEFORE USING IT. NEVER USE DIRTY, CORRODED OR DAMAGED AMMUNITION. A BURST SHOTSHELL MAY RESULT CAUSING DAMAGE TO THE FIREARM AND PERSONAL INJURY OR DEATH TO THE SHOOTER OR BYSTANDERS.

- Use only commercially manufactured ammunition with internal ballistic pressures which are in strict accordance with the specifications of the Sporting Arms and Ammunition Manufacturers' Institute (SAAMI). If you are uncertain, contact your ammunition supplier for verification.



WARNING: NEVER USE NON-STANDARD, RELOADED OR "HANDLOADED" AMMUNITION WHICH HAS NOT BEEN SUBJECTED TO INTERNAL BALLISTIC PRESSURE TESTING. RELOADED OR HANDLOADED AMMUNITION, MAY HAVE MANY MANUFACTURING AND QUALITY VARIABLES (SUCH AS THE TYPE AND AMOUNT OF GUN POWDER). SHOTSHELLS THAT HAVE BEEN RELOADED AND FIRED MULTIPLE TIMES MAY SUFFER PHYSICAL DAMAGE WHICH COULD SIGNIFICANTLY IMPACT OR REDUCE THE INTEGRITY OF THE SHOTSHELL. SHOTSHELL FAILURE AND INJURY TO THE SHOOTER OR BYSTANDERS AND DAMAGE TO THE FIREARM MAY RESULT WHEN SUCH A ROUND IS FIRED. ANY AMMUNITION THAT IS IMPROPERLY MANUFACTURED OR RELOADED, EVEN IN THE SLIGHTEST DEGREE, MAY FAIL TO FIRE OR MAY GENERATE EXCESSIVE INTERNAL PRESSURES WHICH CAN DAMAGE OR EVEN RUPTURE THE FIREARM, CAUSING PERSONAL INJURY OR DEATH TO THE SHOOTER OR THOSE IN THE IMMEDIATE VICINITY.

- A firearm and ammunition are a system and must work together. There are different types of ammunition for different types of firearms. Your firearm has been designed for ammunition of a specific type and a specific Gauge or caliber. It is important to select the proper ammunition for your firearm.

AMMUNITION CONTINUED



WARNING: DISCHARGING FIREARMS IN POORLY VENTILATED AREAS, CLEANING FIREARMS, OR HANDLING AMMUNITION MAY RESULT IN EXPOSURE TO LEAD AND OTHER SUBSTANCES KNOWN TO CAUSE BIRTH DEFECTS, REPRODUCTIVE HARM, AND OTHER SERIOUS PHYSICAL INJURY. HAVE ADEQUATE VENTILATION AT ALL TIMES. WASH HANDS THOROUGHLY AFTER EXPOSURE.

NOTE: The Cylinder bore and Modified screw-in choke tubes that are supplied with the M&P®12 shotgun from the factory can be used with steel shot and lead shot alternatives without damage to the choke tube or shotgun barrel. The M&P®12 shotgun should not be fired using steel shot or alternatives to lead shot if a more restrictive aftermarket choke tube is installed.

NOTE: Shotshells that incorporate slugs with sabots or other types of shells intended to be used with a rifled shotgun barrel are not recommended for use in the M&P®12 shotgun.

NOTE: Please review the Removable Choke Tubes section of this manual for important information regarding choke tube and ammunition compatibility.

CAUTION: Never fire your M&P®12 shotgun without a compatible choke tube properly installed or damage to the internal threads in the barrel will result and could render your shotgun inoperable. With the shotgun unloaded, periodically check to ensure that the choke tube has not become loose due to firing.

- Different combinations of load velocity, load weight and total firearm weight can have major impact on felt recoil; high felt recoil can be uncomfortable to some shooters.
- To acclimate yourself to higher levels of felt recoil, consider the following:
 - Start your shooting experience with the lowest load velocity and lowest load weight available for your firearm.
 - Ask your firearm dealer to suggest the lowest power, lowest velocity ammunition for your shotgun.



WARNING: THE M&P®12 SHOTGUN IS CHAMBERED FOR 12 GAUGE INCLUDING 3 INCH SHELLS. SOME OF THESE SHOTSHELLS CAN DEVELOP HEAVY RECOIL WHEN FIRED. FAILURE TO CONTROL HEAVY RECOIL CAN RESULT IN PERSONAL INJURY AND/OR PROPERTY DAMAGE UPON FIRING. EACH SHOOTER NEEDS TO SELECT THE BEST SHOTSHELL LOAD FOR THEIR RECOIL TOLERANCE LEVEL.

MODEL AND FEATURES IDENTIFICATION

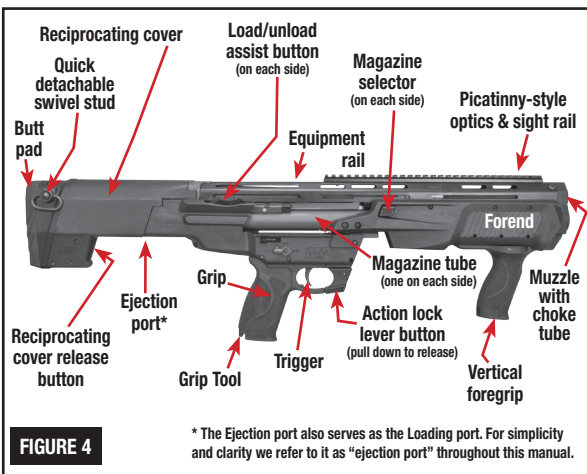
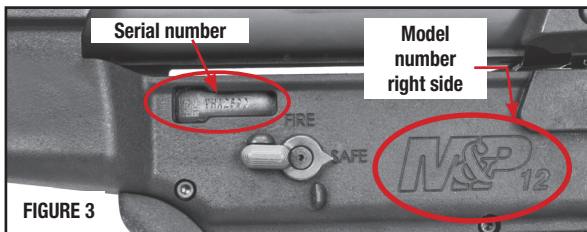
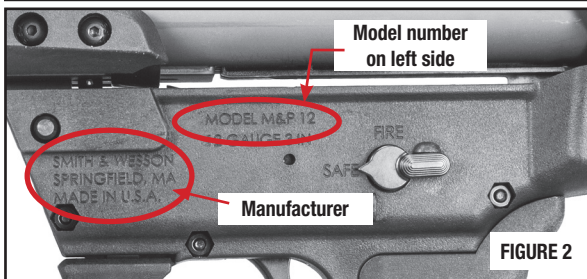

INSPECTING YOUR M&P®12



WARNING: ALWAYS KEEP THE MUZZLE POINTED IN A SAFE DIRECTION.



WARNING: ALWAYS ENSURE THAT THE FIREARM IS UNLOADED BEFORE INSPECTING, DISASSEMBLING, ASSEMBLING OR CLEANING.

- The M&P®12 is a pump-action, select-feed (2 magazines manually selected by the user), single-barrel, bullpup-design repeating shotgun.

- When you inspect your shotgun, you should first check for yourself to ensure that it is unloaded. Never take anyone's word for it.

- Rotate the safety selector lever into the "SAFE" position (from either side of the shotgun) (FIGURE 6).

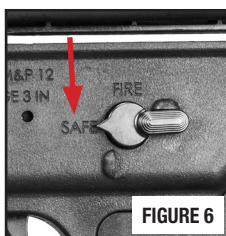

- As shipped from the factory, an empty chamber flag is used to indicate that no round of ammunition is present in the chamber (FIGURE 7).

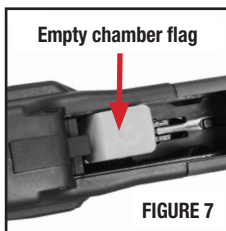

- Grasp the shotgun with your finger off the trigger and outside the trigger guard, point the muzzle in a safe direction, open the action by grasping the vertical foregrip and drawing it rearward (FIGURE 8).

- Remove the empty chamber flag from the shotgun (FIGURE 9).

FIGURE 8

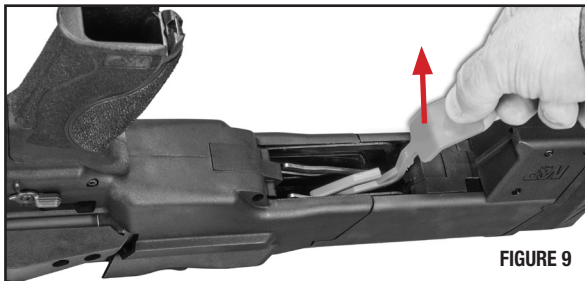

INSPECTING YOUR M&P®12 CONTINUED

- Look into the ejection port and verify that no ammunition is present in either left or right magazine tube (FIGURE 10).
- Look into the ejection port and check the chamber to be sure that no shotshell is present (FIGURE 10).
- If any ammunition has been loaded into the magazines, you should remove the ammunition at this point. Proceed to the section of this manual that details UNLOADING and follow those instructions.

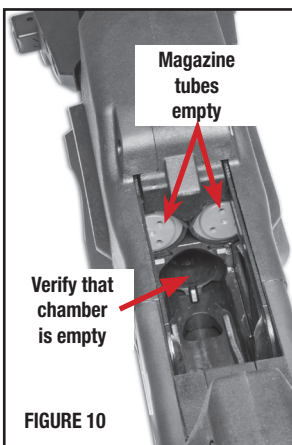

- Return the action fully forward (using the vertical foregrip) until the action closes and locks shut (FIGURE 11).



- If the action is closed and no empty chamber flag is present when you encounter this firearm, grasp the shotgun with your finger off the trigger and outside the trigger guard, rotate the safety lever to the SAFE position, point the muzzle in a safe direction, open the action by pressing/pulling down on the action lock (FIGURE 12), grasping the vertical foregrip and drawing it fully rearward. Look into the ejection port and ensure that no shotshells are present in the chamber or in the magazines.



- If any ammunition has been loaded into the magazines, you should remove the ammunition at this point. Proceed to the section of this manual that details UNLOADING and follow those instructions.
- Before using your firearm for the first time, it should be cleaned.
- You must follow this procedure every time a firearm leaves your hand, is cleaned, is handed to you or another person, is transported or it is stored.

INSPECTING YOUR M&P®12 CONTINUED



WARNING: NEVER RELY ON MECHANICAL FEATURES ALONE. ONLY YOUR SAFE FIREARM HANDLING WILL ENSURE THE SAFE USE OF YOUR FIREARM. THIS IS YOUR RESPONSIBILITY.

NOTE: A video on the safe handling and maintenance of the M&P®12 is available at www.smith-wesson.com.

PREPARATION FOR FIRING



WARNING: THE FAILURE TO FOLLOW THESE FIREARM SAFETY REQUIREMENTS WILL CAUSE SERIOUS PERSONAL INJURY OR DEATH TO YOU OR OTHERS.

- **ALWAYS TREAT ALL FIREARMS AS IF THEY ARE LOADED.**
- **ALWAYS BE SURE THAT ALL ACTIONS OF FIREARMS ARE OPEN, THAT CHAMBERS ARE CLEAR OF SHOTSHELLS AND MAGAZINES ARE UNLOADED AND THAT THE FIREARM MUZZLE IS POINTING IN A SAFE DIRECTION.**
- **ALWAYS KEEP FINGERS AND OTHER BODY PARTS AWAY FROM THE MUZZLE AND AWAY FROM THE POSSIBLE PINCH POINTS OF THE FIREARM.**
- **ALWAYS WEAR ADEQUATE AND PROPER HEARING PROTECTION SPECIFIED FOR FIREARM USE** to prevent permanent damage to your hearing. Make sure others who are nearby are wearing hearing protection as well.
- **ALWAYS WEAR SAFETY GLASSES SPECIFIED FOR FIREARM USE**, whether indoors or out. Safety glasses should protect your eyes from the firing flash and particles associated with the discharge of ammunition. Failure to do so creates a risk of personal injury from particle or debris spitting or from a ricochet.
- **ALWAYS BE ALERT AND ALWAYS FOLLOW THE SAFETY INSTRUCTIONS OF THE RANGE OFFICER.** Never shoot if you are tired, cold or impaired in any way.
- **ALWAYS BE AWARE OF OTHER PEOPLE** so that persons do not accidentally walk into the line of fire.
- **THE SHOOTER (AND ALL OTHERS IN THE SHOOTING AREA) MUST ALWAYS BE IN A POSITION THAT IS OUT OF THE LINE OF FIRE** and are not within an area where they may be struck by a ricochet or particles spitting from a firearm, or by ejected cases from some types of firearms.
- **NEVER SHOOT AT SURFACES THAT MAY CAUSE A RICOCHET.** Always select a place to shoot that has a safe backstop, is free from obstructions and has no surfaces that may cause a ricochet.

PREPARATION FOR FIRING CONTINUED

- **NEVER FIRE RANDOMLY INTO THE SKY.** Always select a place to shoot that has a safe backstop.
- **NEVER USE ALCOHOL OR DRUGS BEFORE OR WHILE SHOOTING OR HANDLING ANY FIREARM.**

LOADING



WARNING: ALWAYS KEEP THE MUZZLE POINTED IN A SAFE DIRECTION.



WARNING: ALWAYS KEEP YOUR HANDS BEHIND THE MUZZLE. FAILURE TO DO SO WHILE FIRING THE SHOTGUN WILL RESULT IN SERIOUS BODILY INJURY OR DEATH.

- Do not load the shotgun until you have read and understand this manual fully.
- Do not load the shotgun until you are ready to use it. Keep your finger off the trigger and outside the trigger guard until you are ready to fire.
- Never load your shotgun until you are sure of your target, what is beyond it and are fully prepared to fire.

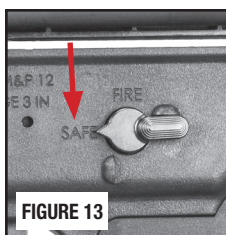

- Set safety selector lever to “SAFE” (FIGURE 13) (it functions the same from either side of the shotgun).
- Pull (FIGURE 14a) or press (FIGURE 14b) down on the action lock lever button and pull the vertical foregrip all the way back until it stops, to open the mechanism to verify that both magazines and the chamber are empty (FIGURE 15).

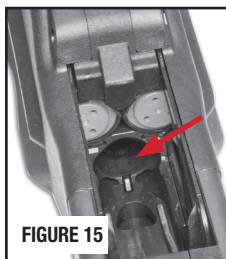

LOADING CONTINUED

- Return the slide (using the foregrip) to the fully forward position (FIGURE 16) to close the bolt on an empty chamber.
- With the muzzle pointed in a safe direction, hold the shotgun so the ejection port is visible to you.
- Orient the shotshell as shown (FIGURE 17), insert the shell forward into the magazine tube with a quick push until the shell's rim engages the load/unload assist button that will hold the shotshell in the magazine.

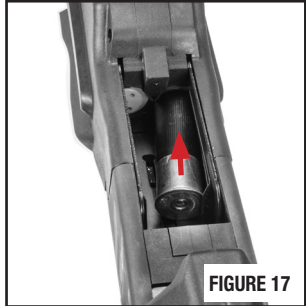

NOTE: It will ease loading to depress the load/unload assist button (one on each side/magazine tube) at its front surface on the magazine tube you are loading shells into (FIGURE 18). Depress the load/unload assist button as you start to insert each shell and then release the lever once the shell is fully in the magazine - this will hold the loaded shell in place in the magazine tube while the next round is handled.

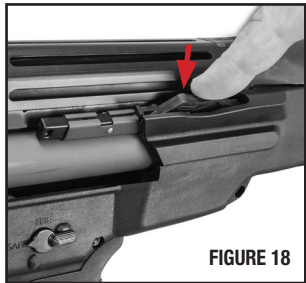

- Smith & Wesson has found that resting the muzzle of the shotgun on a solid surface (that is free of contaminants that could enter the muzzle) makes loading easier (FIGURES 19a and 19b).

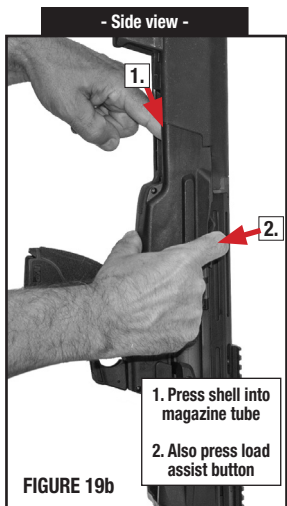
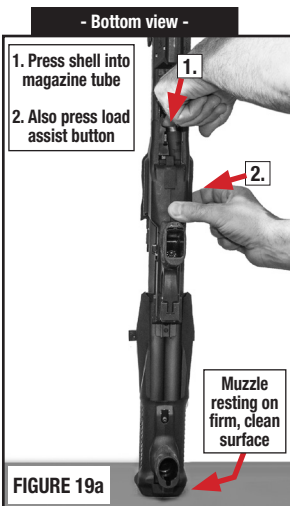

LOADING CONTINUED

- Once the magazines are loaded, use the push-button magazine selector to select the magazine you want to fire from first (FIGURES 20a and 20b).

CAUTION: Only move the magazine selector when the action is fully closed. Attempting to move the magazine selector with the action unlocked will damage and disable the shotgun.

- The side from which the button projects is the active feeding tube.
- With the shotgun pointed in a safe direction, press down on the action lock lever button (FIGURE 21) to release the lock, allowing the vertical foregrip to be drawn fully rearward and then fully forward (closed). This activity will draw a shell from the selected magazine tube and insert it into the chamber.
- The shotgun is now loaded and ready to fire once the safety selector lever is rotated to the FIRE position and the trigger is pulled.

- The M&P®12 user can now restore the shotgun to full capacity (if desired) by topping off the magazine - adding one round to the selected magazine tube through the ejection port.

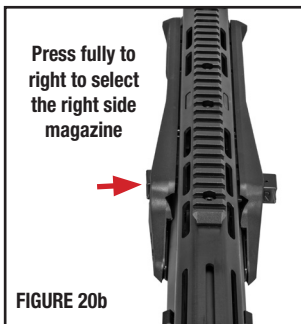

WARNING: NEVER FEED A ROUND DIRECTLY INTO THE CHAMBER. ALWAYS LOAD A ROUND INTO THE CHAMBER BY FEEDING IT FROM THE MAGAZINE.

NOTE: The magazine selector button does not automatically switch after feeding all of the shells from one magazine tube. The selector must be manually pressed by the user to select the opposite side.

The user may switch back and forth between the active feeding magazine tube as desired by pressing the selector to the desired tube during a firing sequence.

LOADING CONTINUED

To manipulate the magazine selector, the vertical foregrip (and action) must be in the fully forward (closed) position.

NOTE: If the shotgun is laid down on a hard surface, the magazine selector button can be inadvertently pressed to the opposite side, thereby selecting the opposite magazine.

M&P®12 TACTILE LOADED CHAMBER INDICATOR



WARNING: NEVER RELY UPON THE TACTILE LOADED CHAMBER INDICATOR ALONE TO VERIFY THE PRESENCE OR ABSENCE OF A ROUND IN THE CHAMBER.

THE SUREST METHOD TO DETERMINE THE PRESENCE OR ABSENCE OF A ROUND IN THE CHAMBER IS TO VISUALLY CHECK THE CHAMBER OF YOUR FIREARM BY UNLOCKING AND OPENING THE ACTION AND OBSERVING THE CHAMBER FOR YOURSELF.



WARNING: ALWAYS TREAT EVERY FIREARM AS IF IT IS LOADED AND WILL FIRE IF THE TRIGGER IS PULLED. A LOADED CHAMBER INDICATOR MAY HELP DETERMINE WHETHER THE CHAMBER IS LOADED OR UNLOADED.

- The M&P®12 shotgun comes with a tactile loaded chamber indicator. This indicator can be observed by looking at the top of the firearm (FIGURE 22), noting a lever that may be raised above the radial surface.
- If this lever is visible and can be felt above the radial surface of the barrel extension, a shotshell is in the shotgun's chamber.
- If no shotshell is in the chamber, you will not be able to feel and see the lever raised above the radial surface of the barrel extension (FIGURE 23).

Tactile loaded chamber indicator is raised up when a shotshell is in the chamber

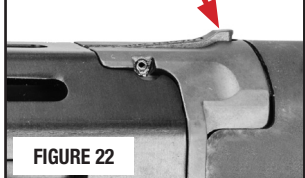

Tactile loaded chamber indicator is flush with the top of the radial surface of the barrel extension when no shotshell is in the chamber

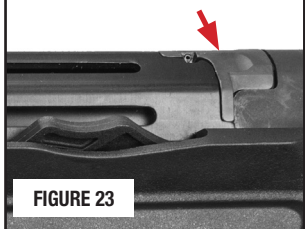

FIRING



WARNING: ALWAYS KEEP THE MUZZLE POINTED IN A SAFE DIRECTION.



WARNING: WEAR EYE AND HEARING PROTECTION SPECIFIED FOR FIREARM USE EVERY TIME YOU DISCHARGE YOUR FIREARM. MAKE SURE OTHERS IN THE VICINITY OF WHERE YOU WILL BE SHOOTING DO SO AS WELL.



WARNING: ALWAYS KEEP YOUR HANDS BEHIND THE MUZZLE. DUE TO THE SHORT BULLPUP DESIGN OF THIS SHOTGUN, SPECIAL CARE MUST BE TAKEN TO NEVER DISCHARGE THE FIREARM WITH ANY PART OF THE BODY EXTENDED PAST THE MUZZLE. WE STRONGLY RECOMMEND ONLY DISCHARGING THE SHOTGUN WHEN BOTH HANDS ARE ON THE FIREARM GRIPS. CARE SHOULD BE TAKEN DURING RAPID PUMPING AND FIRING TO PREVENT YOUR NON-TRIGGER HAND FROM SLIPPING OFF THE GRIP AND OUT IN FRONT OF THE MUZZLE.



WARNING: FIRING THE M&P®12 WITH THE FOREGRIP REMOVED COULD CREATE AN ENHANCED RISK OF YOUR NON-TRIGGER HAND SLIPPING IN FRONT OF THE MUZZLE WHILE FIRING. BE CERTAIN THAT THE FOREGRIP USED ON YOUR M&P®12 IS SECURELY ATTACHED. A LOOSE OR INCORRECTLY INSTALLED FOREGRIP CAN FAIL DURING FIRING RESULTING IN YOUR NON-TRIGGER HAND MOVING OUT IN FRONT OF THE MUZZLE, CAUSING SERIOUS INJURY AND/OR DEATH.



WARNING: DO NOT “SHOOT FROM THE HIP”, OR FIRE THE SHOTGUN IN ANY MANNER IN WHICH IT IS NOT FULLY SUPPORTED BY YOUR SHOULDER. FIRING THE SHOTGUN IN AN UNSUPPORTED MANNER CAN RESULT IN LOSS OF CONTROL AND CAN LEAD TO INJURY TO THE SHOOTER OR BYSTANDERS AND DAMAGE TO PROPERTY. NEVER FIRE THE SHOTGUN WITHOUT FULLY SUPPORTING IT BY YOUR SHOULDER. NEVER FIRE THE SHOTGUN WITHOUT DELIBERATELY AIMING AT AN INTENDED TARGET.

- Grasp firearm with one hand on the vertical foregrip and other hand on the shotgun grip with index finger resting along outside of trigger guard. Raise shotgun and pull the butt pad firmly against your shoulder (FIGURE 24).



FIRING CONTINUED

- Rotate the safety selector lever to the “FIRE” position (on either side of the shotgun) (FIGURE 25).

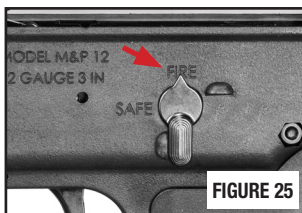

- While aiming, place your index finger on the trigger and pull until the shotgun fires.
- You may continue to fire by cycling the action fully to the rear and then fully forward with the vertical foregrip and then pulling the trigger to fire until the chosen magazine is empty.
- To switch to the second magazine tube and continue firing, push the vertical foregrip fully forward to close the action, then push the magazine selector to the opposite side, allowing the shells from the other tube to be fed into the chamber by cycling the action.

NOTE: The magazine selector can only be manipulated when the action is in its forward position (closed).

- If you wish to stop firing, remove your finger from the trigger and keep it outside the trigger guard, then rotate the safety selector lever to the “SAFE” position.

CLEARING A MISFIRE



WARNING: ALWAYS KEEP THE MUZZLE POINTED IN A SAFE DIRECTION.



WARNING: WEAR EYE AND HEARING PROTECTION SPECIFIED FOR USE WITH FIREARMS WHEN FIRING AND CLEARING MISFIRES OR JAMS.



WARNING: IF YOUR FIREARM GIVES ANY INDICATION THAT IT IS NOT PERFORMING PROPERLY OR THE OPERATION OF YOUR FIREARM HAS CHANGED “THE WAY IT FEELS OR SOUNDS”, STOP FIRING. MAKE SURE THE FIREARM IS POINTED IN A SAFE DIRECTION, UNLOAD THE FIREARM AND HAVE IT INSPECTED AND TEST FIRED BY A GUNSMITH QUALIFIED TO PERFORM SERVICE ON SMITH & WESSON FIREARMS.

TO CLEAR A MISFIRE

- If a shotshell fails to fire, wait 30 seconds while keeping the muzzle pointed in a safe direction.
- Keep your finger off the trigger and outside of the trigger guard.
- Rotate the safety selector lever to the SAFE position (FIGURE 26).

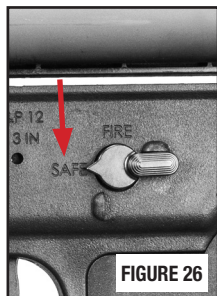

CLEARING A MISFIRE CONTINUED

- After 30 seconds, press the action lock lever button down and open the action by pulling the vertical foregrip fully rearward while keeping the ejection port pointed away from you or any bystanders.



WARNING: KEEP YOUR FACE A SAFE DISTANCE FROM THE EJECTION PORT AND MAGAZINE WELL WHEN CLEARING A MISFIRED SHOTSHELL. A SHOTSHELL MAY IGNITE IF THE PRIMER OF THE SHOTSHELL IS STRUCK WITH SUFFICIENT FORCE. IF A SHOTSHELL IGNITES WHILE BEING CLEARED FROM THE FIREARM, DEATH OR SERIOUS INJURY MAY RESULT.

- Once the misfired shotshell is cleared, proceed to load the firearm as instructed in the Loading Section.
- Dispose of defective shotshell(s) in a method specifically approved for live round disposal. Do not use damaged ammunition in any firearm.

CLEARING A JAM

When in the process of cycling the action of the M&P®12 the following scenarios would be considered a jam or stoppage:

1st Scenario - Shotgun action fails to close, i.e. the action cannot be closed with a shotshell in the chamber because the shotshell is damaged or deformed.

2nd Scenario - Double-feed of shotshells from the magazine tube during the process of cycling the action.

- The recovery procedure for both of these “jams” is as follows:
- Rotate the safety selector lever to the SAFE position.
- While keeping the firearm’s muzzle pointed in a safe direction, open the action as far as possible by pulling the vertical foregrip as far rearward as it will travel (FIGURE 27).

FIGURE 27

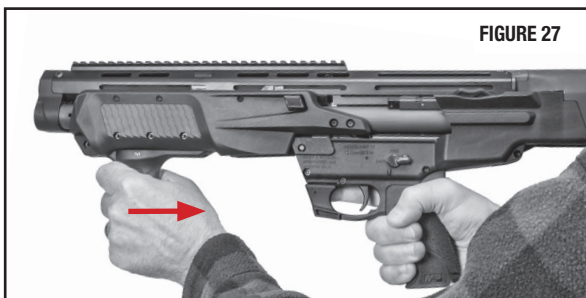

CLEARING A JAM CONTINUED

- Depress the reciprocating cover release button and pull the reciprocating cover as far rearward as it will travel, approximately 1¾ inches (FIGURE 28).

- Remove all shotshells that make up the jam from the ejection port.

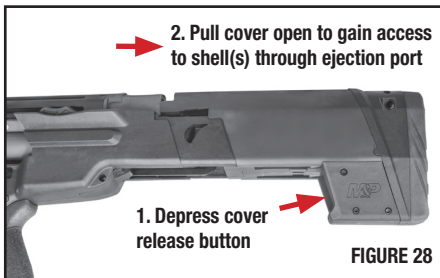

- Push the reciprocating cover forward to the closed position (FIGURE 29).

NOTE: There is an interlock between the action and the reciprocating (stock) cover. If you attempt

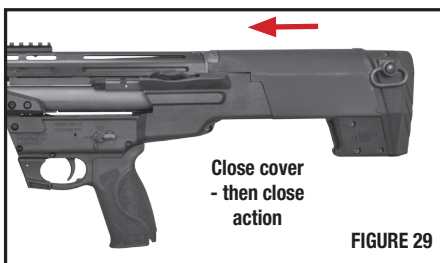

to close the action without returning the reciprocating cover to the closed position, the action will be prevented from closing.

- At this point the M&P®12 shotgun has been returned to operational condition and the user can resume firing.
- When attempting to clear a jam use extreme care to avoid striking the primer of the shotshell(s).

UNLOADING



WARNING: ALWAYS KEEP THE MUZZLE POINTED IN A SAFE DIRECTION.

- Rotate the safety selector lever to the SAFE position (FIGURE 30).
- Smith & Wesson advises against repeatedly chambering and ejecting each shell to remove all of the shotshells from the firearm. Instead the shotshells should be removed one at a time as follows:
 - Place a finger against the shotshell in the magazine tube that you want to remove (reaching into the ejection port).
 - Press the load/unload assist button (just long enough to release one shotshell at a time) for the magazine tube you want to empty (separate lever for the left and the right tube) and remove all shotshells from the shotgun one at a time (FIGURE 31).
 - Catch the shotshells as they come clear of the magazine tube into the ejection port.
 - Once the magazines are both empty, pull/press the action lock lever button down and open the action by drawing the vertical foregrip fully rearward (FIGURE 32).
 - If a round had previously been loaded into the chamber, that shell will be ejected during this process.
- Look into the ejection port at the chamber and the magazine tubes to ensure that the shotgun is empty and clear of all ammunition (FIGURE 33).
- Collect live ammunition for safe storage and the spent shotshell hulls for proper disposal.



FIGURE 30

Press front of lever down (for both left and right magazine tubes) to free shells

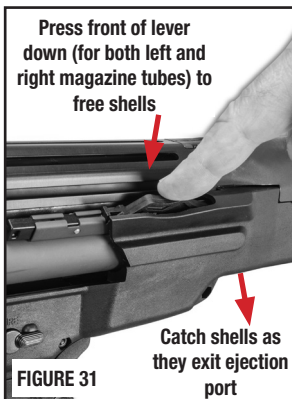

FIGURE 31



FIGURE 32

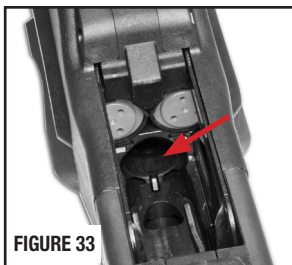

FIGURE 33

DISASSEMBLY/FIELD STRIPPING



WARNING: ALWAYS KEEP THE MUZZLE POINTED IN A SAFE DIRECTION.



WARNING: UNLOAD THE FIREARM BY FOLLOWING THE UNLOADING INSTRUCTIONS.



WARNING: NEVER DO ANYTHING BEYOND WHAT YOU ARE SPECIFICALLY INSTRUCTED TO DO IN THIS MANUAL. NEVER ALTER OR MODIFY THE PARTS IN YOUR FIREARM.



WARNING: WEAR SAFETY GLASSES THAT ARE SPECIFIED FOR USE WITH FIREARMS EVERY TIME YOU ASSEMBLE OR DISASSEMBLE YOUR FIREARM.



WARNING: ANY MAINTENANCE, ADJUSTMENT OR SERVICE NOT SPECIFIED IN THIS MANUAL MAY AFFECT THE SAFETY AND RELIABILITY OF YOUR FIREARM AND MUST BE PERFORMED BY A QUALIFIED GUNSMITH USING GENUINE SMITH & WESSON PARTS. IF YOU DO OTHERWISE, IMPROPER FUNCTIONING OF YOUR FIREARM MAY OCCUR AND SERIOUS INJURY OR DEATH MAY RESULT.



FIGURE 34



FIGURE 35

- Rotate the safety selector lever into the “SAFE” position (from either side of the shotgun) (FIGURE 34).
- Pull/press the action lock lever button down (FIGURE 35) and open the action of the shotgun by pulling rearward on the foregrip. Ensure that the chamber and magazine tubes are not loaded (FIGURE 36).
- Close the action by pushing the foregrip fully forward until the action locks closed.
- Remove the Grip Tool from the bottom of the rear grip by turning the base of the tool 1/4 turn in either direction and withdrawing it from its recess (FIGURES 37 and 38).

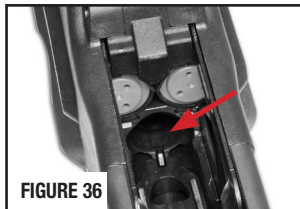

FIGURE 36



FIGURE 37



FIGURE 38

DISASSEMBLY - FIELD STRIPPING CONTINUED

- Turn the M&P®12 shotgun upside down and look into the ejection port to locate the half-moon cutout along the side of the bolt tray (FIGURE 39).

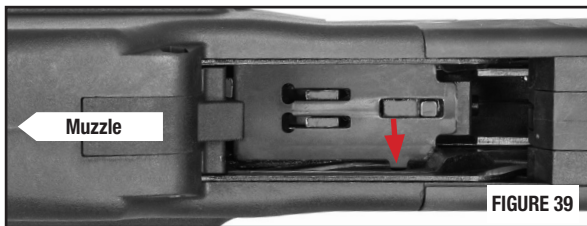

- FIGURE 40 shows the location of the reciprocating cover latch button.



- There are two steps involved in opening the stock cover:

Step 1 - Initial cover unlocking.

Step 2 - Opening cover fully.

- Insert the Grip Tool shaft into the half-moon cutout and depress the interlock against its spring about 1/8" down (FIGURE 41).
- While holding the Grip Tool down against the interlock, also depress the cover latch button and pull the rear section of the butt stock assembly approximately 1/4" to the rear (FIGURE 42). Stop pulling once the small gap appears.

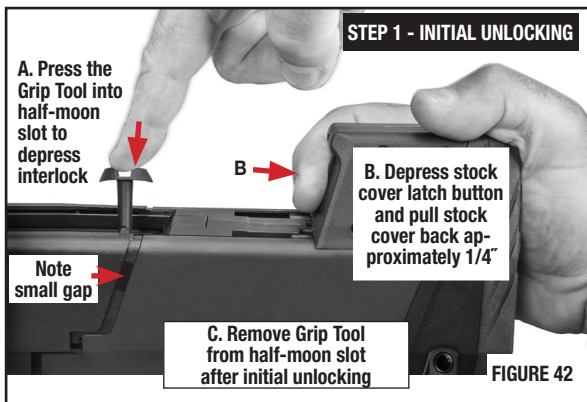

- Withdraw the Grip Tool from its recess and set the tool aside.

DISASSEMBLY - FIELD STRIPPING CONTINUED

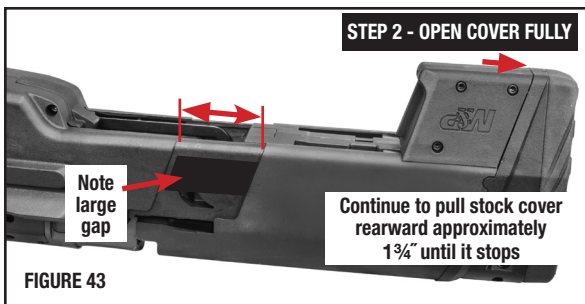

- Grasp the rear section of the butt stock and continue to draw it fully rearward (about 1 3/4" inches) while holding onto the foregrip for leverage (FIGURE 43).



- FIGURE 44 shows the location of the takedown pin.

- Use the Grip Tool to push the takedown pin out of its recess (FIGURE 45) until it comes to a positive stop. The takedown pin is captive and does not come out completely.

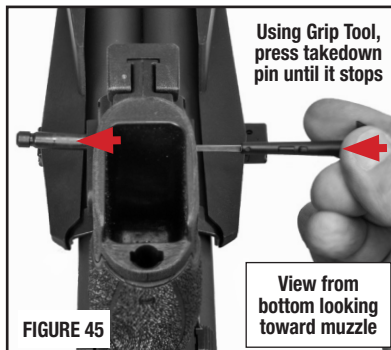

- Grasp the "upper receiver" assembly in one hand and the "lower receiver" in the other hand and pull them apart.



- You now have the shotgun disassembled/field stripped so cleaning can take place (FIGURES 46 and 47).



NOTE: Never dry-fire the shotgun while it is disassembled. Damage to the shotgun parts could result.

DISASSEMBLY - FIELD STRIPPING CONTINUED

- Drawing the vertical foregrip/ action rearward at this point will allow the bolt to come clear of the barrel breech - causing the bolt to be unlocked so it can be separated from the mechanism (FIGURES 48 and 49) and cleaned. The shotgun's bore can also be cleaned once the bolt is removed.

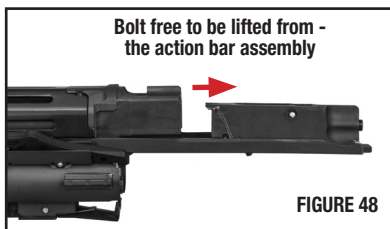

WARNING: DO NOT DISASSEMBLE THE BOLT ASSEMBLY. IT CAN BE CLEANED EFFECTIVELY WITHOUT DISASSEMBLY.



WARNING: NO FURTHER DISASSEMBLY SHOULD BE PERFORMED BY THE USER. NEVER ALTER OR MODIFY THE PARTS IN YOUR FIREARM.

- Once cleaned, the shotgun can be reassembled.

NOTE: A video on the safe handling and maintenance of the M&P®12 is available at www.smith-wesson.com.

REASSEMBLY



WARNING: ALWAYS FOLLOW THE FIELD STRIPPING INSTRUCTIONS EXACTLY. NEVER DO ANYTHING BEYOND WHAT YOU ARE SPECIFICALLY INSTRUCTED TO DO IN THIS MANUAL. NEVER ALTER OR MODIFY THE PARTS IN YOUR FIREARM.



WARNING: WEAR SAFETY GLASSES SPECIFIED FOR USE WITH FIREARMS EVERY TIME YOU DISASSEMBLE OR ASSEMBLE YOUR FIREARM.

- FIGURE 50 shows the action bar assembly and the bolt itself in the proper orientation for reassembly.

- Assemble your shotgun in the reverse order that you took it apart.

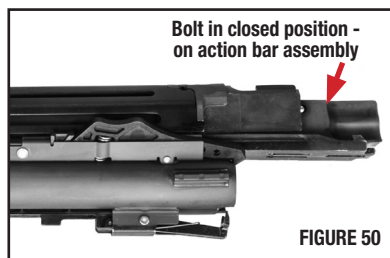

REASSEMBLY CONTINUED

- Lubricate all metal parts by wiping them with a cloth dampened with a high quality firearm oil. Remove excess oil. Leave a light film of oil on all metal parts of your shotgun - inside and out.

- Replace bolt on action bar (FIGURES 51 and 52a).

- Close bolt into breech by sliding foregrip toward muzzle (FIGURE 53).

NOTE: If the bolt lock prematurely cams upward, it will hit on the back of the barrel extension, preventing reassembly (FIGURE 52b). If this occurs, slide the bolt forward a little on the action bar, thereby allowing the bolt lock to go downward (out of the way).

Proceed to close the action slowly, and if necessary, apply light force on the back of the bolt assembly to prevent the bolt lock from raising upward and interfering with reassembly.

- Grasp “upper” in one hand and “lower” in other hand.

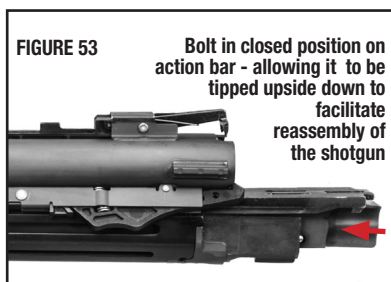
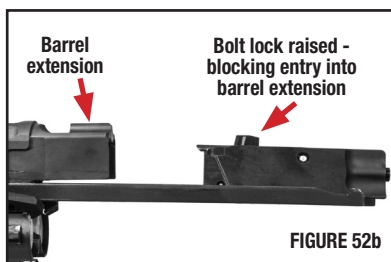
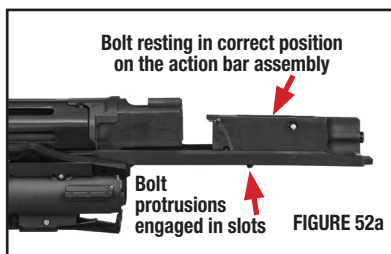
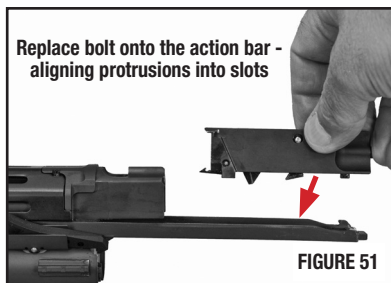

REASSEMBLY CONTINUED

FIGURE 54

UPPER

Tabs that align "upper" in "lower" slots when reassembling



LOWER

Tabs on "upper" go into slots here in "lower" when reassembling

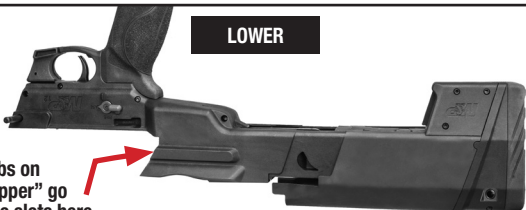
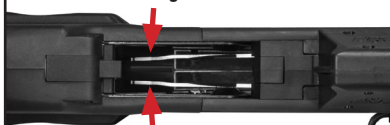

FIGURE 55

- Guide the tabs on the magazine tubes (FIGURE 54) into the corresponding slots in the "lower" (FIGURE 55).

FIGURE 56

View from bottom showing location of elevator bars



Keep elevator bars alongside bolt when reassembling

- Keep the silver colored elevator bars (FIGURE 56) alongside the bolt when sliding the upper and lower together. If the elevator bars are positioned above the action bar the shotgun will not function correctly.

FIGURE 57



- Align the holes in the upper (FIGURE 57) and the lower/takedown pin (FIGURE 58) to allow the takedown pin to be reinserted. Some pinching together of the upper and lower will be required to align the holes.

FIGURE 58



REASSEMBLY CONTINUED

- Insert the takedown pin (FIGURE 59) so it is flush at the sides with the housing (FIGURE 60).

Press takedown pin in once holes in “upper” and “lower” are aligned.

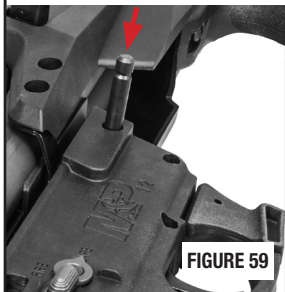

The takedown pin is retained by an internal detent when it is flush with outer surface.



- Collapse the reciprocating cover into its closed position by pressing forward on the butt pad while gripping the vertical foregrip in the other hand (FIGURES 61a and 61b).



NOTE: A video on the safe handling and maintenance of the M&P®12 is available at www.smith-wesson.com.



WARNING: FIRING THE M&P®12 WITH THE FOREGRIP REMOVED COULD CREATE AN ENHANCED RISK OF YOUR NON-TRIGGER HAND SLIPPING IN FRONT OF THE MUZZLE WHILE FIRING. BE CERTAIN THAT THE FOREGRIP USED ON YOUR M&P®12 IS SECURELY ATTACHED. A LOOSE OR INCORRECTLY INSTALLED FOREGRIP CAN FAIL DURING FIRING RESULTING IN YOUR NON-TRIGGER HAND MOVING OUT IN FRONT OF THE MUZZLE, CAUSING SERIOUS INJURY AND/OR DEATH.

INSTALLATION OF SIGHTS AND OPTICS

- Smith & Wesson recommends that you have a competent gunsmith install your optical sight/scope (FIGURE 62a) or detachable sights (FIGURE 62b).



WARNING: ALWAYS ENSURE THAT THE FIREARM IS UNLOADED BEFORE INSTALLING A SCOPE, OPTICAL SIGHT OR ANY OTHER ACCESSORIES. FAILURE TO DO THIS CAN RESULT IN INJURY OR DEATH TO YOU OR OTHERS AND DAMAGE TO PROPERTY.



WARNING: FIRING A FIREARM WITH YOUR EYE TOO CLOSE TO THE EYE PIECE OF A SCOPE OR OPTICAL SIGHT, OR FAILING TO HOLD THE FIREARM SECURELY AGAINST RECOIL, MAY RESULT IN SERIOUS PERSONAL INJURY INCLUDING, BUT NOT LIMITED TO, BLINDNESS.



WARNING: A SCOPE OR SIGHT WHICH IS NOT SECURELY MOUNTED MAY BECOME DETACHED UPON RECOIL OF THE FIREARM. IF IT BECOMES DETACHED IT MAY FLY BACK AND STRIKE THE SHOOTER OR A BYSTANDER AND CAUSE INJURY. OBSERVE THE CONDITION OF ALL THE SCOPE MOUNT SCREWS AFTER FIRING. IF THE MOUNTING SCREWS SHOW SIGNS OF LOOSENING DO NOT FIRE THE GUN AGAIN; CALL THE CUSTOMER SERVICE DEPT. FOR ASSISTANCE AT 1-800-331-0852 EXT 4125.

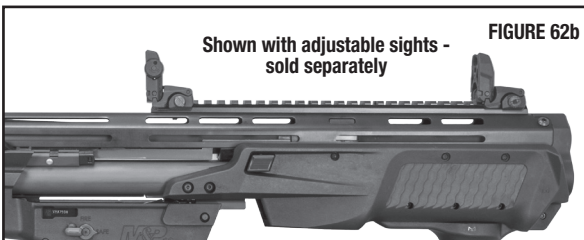

- Scopes and optical sights have varying lengths of recommended eye relief. You need to choose a combination that allows for adequate clearance between the scope or sight and your eye. Follow the instructions supplied with the scope and scope rings or sight for proper installation.

REMOVABLE CHOKE TUBES



WARNING: NEVER ATTEMPT TO INSPECT, INSTALL OR REMOVE A CHOKE TUBE FROM A LOADED SHOTGUN. ALWAYS ENSURE THAT THE SHOTGUN IS UNLOADED. FAILURE TO FOLLOW THIS WARNING COULD RESULT IN AN ACCIDENTAL DISCHARGE CAUSING INJURY AND/OR DEATH TO THE SHOOTER OR BYSTANDERS AND DAMAGE TO PROPERTY.

The M&P®12 shotgun is supplied from the factory with Cylinder bore and Modified bore screw-in (removable) choke tubes (FIGURE 63). These choke tubes can be used with steel shot and lead shot alternatives without damage to the choke tube or shotgun barrel. The M&P®12 shotgun should not be fired using steel shot or alternatives to lead shot if a more restrictive aftermarket choke tube is installed. The M&P®12 shotgun is compatible with REM® choke tubes as well as choke tubes that are interchangeable with REM® choke tubes.

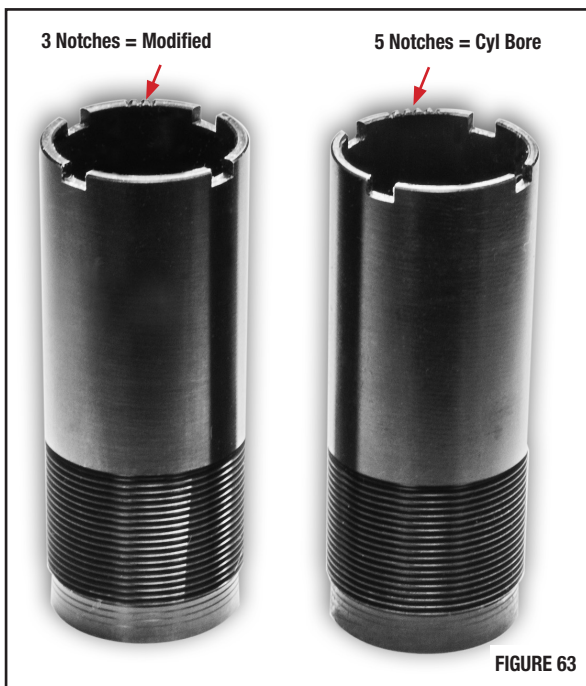

WARNING: NEVER ATTEMPT TO USE ANY NON-COMPATIBLE CHOKE TUBE IN A M&P®12 SHOTGUN. MISMATCHING CHOKE TUBES IN ANY SHOTGUN COULD RESULT IN DAMAGE TO THE SHOTGUN, OR SERIOUS INJURY AND/OR DEATH TO THE SHOOTER OR BYSTANDERS AND DAMAGE TO PROPERTY.

REMOVABLE CHOKE TUBES CONTINUED



WARNING: FAILURE TO USE A PROPERLY INSTALLED CHOKE TUBE, OR USE OF A DAMAGED OR DEFORMED CHOKE TUBE, IN YOUR M&P®12 SHOTGUN CAN RESULT IN AN OBSTRUCTION AND FAILURE OF THE BARREL AND CAUSE SERIOUS INJURY AND/OR DEATH TO THE SHOOTER OR BYSTANDERS AND DAMAGE TO PROPERTY.



WARNING: FIRE RIFLED SLUGS ONLY WITH THE CYLINDER BORE CHOKE TUBE INSTALLED.

CAUTION: Never fire your M&P®12 shotgun without a compatible choke tube properly installed or damage to the internal threads in the barrel will result and could render your shotgun inoperable. With the shotgun unloaded, periodically check to ensure that the choke tube has not become loose due to firing.

- The threads of your choke tubes should be kept clean and lightly lubricated at all times - with a good anti-seize lubricant. When installing the choke tube into the barrel, make sure the muzzle is pointed away from you in a safe direction, and never “force” the choke tube into the barrel. If the tube does not screw in easily, the threads in the barrel or tube could be clogged, or you could be cross threading the parts. The choke tube should screw in easily by hand using the supplied wrench (FIGURE 64). Use the wrench to tighten the tube into the muzzle until it is snug. **DO NOT OVER-TIGHTEN** it as it could damage the tube.



FIGURE 64

- Wrench shown here (FIGURE 65) engaging the slots in the choke tube. To install, turn clockwise. To remove the choke tube turn counter-clockwise.
- Remove the wrench from the choke tube prior to firing.



FIGURE 65

NOTE: Shotshells that incorporate slugs with sabots or other types of shells intended to be used with a rifled shotgun barrel are not recommended for use in the M&P®12 shotgun.

NOTE: Always follow the installation and use directions supplied with any compatible aftermarket choke tube.

SLING SWIVEL INFORMATION



WARNING: NEVER ATTEMPT TO INSTALL OR REMOVE ACCESSORIES FROM A LOADED FIREARM. ALWAYS ENSURE THAT THE FIREARM IS UNLOADED.

FAILURE TO FOLLOW THIS WARNING COULD RESULT IN AN ACCIDENTAL DISCHARGE CAUSING INJURY AND/OR DEATH TO THE SHOOTER OR BYSTANDERS AND DAMAGE TO PROPERTY.

- The M&P®12 shotgun has a socket (on each side) at the rear of the stock assembly where the quick-release sling swivel can be installed (FIGURE 66). By depressing the center button of the swivel (FIGURE 67), it can then be withdrawn from the socket in the shotgun and relocated if desired.



FIGURE 66

The arrow points to the button that when depressed allows the swivel to be withdrawn from its socket



FIGURE 67

- Ensure that the quick-release sling swivel is firmly seated into the socket before allowing the full weight of the firearm to be suspended from a sling.

INTERCHANGEABLE PALMSWELL GRIP INSERTS



WARNING: ALWAYS KEEP THE MUZZLE POINTED IN A SAFE DIRECTION.



WARNING: MAKE SURE THE FIREARM IS UNLOADED BEFORE CHANGING THE INTERCHANGEABLE PALMSWELL GRIP INSERTS.

- If the interchangeable palmswell grip insert currently on your shotgun does not fit your hand comfortably, you can install one of four different sizes that come with the M&P®12 shotgun from the factory (Small, Medium, Medium-Large and Large).



FIGURE 68

- Remove the Grip Tool from the bottom of the grip by rotating it 1/4 turn (either direction) and pulling it down and out of the frame (FIGURES 68 and 69).



FIGURE 69

- Take the current interchangeable palmswell grip insert off the shotgun by tipping it out at the bottom and pulling it down out of its recess (FIGURE 70 through FIGURE 72).



FIGURE 70

- Replace the insert that was in place on the shotgun with the desired interchangeable palmswell insert. Reverse these steps to install the new size.



FIGURE 71

- Replace the Grip Tool in the hole at the bottom of the grip and turn 1/4 turn to secure it in place.

CAUTION: Some solvents may cause damage to the interchangeable palmswell insert material. See the “Cleaning and Maintenance” section of this manual for more information.



FIGURE 72

INTERCHANGEABLE GRIP INSERTS CONTINUED



FIGURE 73

NOTE: The shotgun comes with interchangeable palmswell grip inserts in Small, Medium, Medium-Large and Large sizes. The size of each is marked on both the inside surface and the outside of the interchangeable palmswell grip insert (FIGURES 73 and 74).



FIGURE 74

CLEANING AND MAINTENANCE



WARNING: ENSURE THAT YOUR FIREARM IS UNLOADED BEFORE BEGINNING TO CLEAN IT. (SEE “INSPECTING YOUR FIREARM” SECTION). ALWAYS FOLLOW THE RULES OF SAFE FIREARM HANDLING.



WARNING: WEAR SAFETY GLASSES EVERY TIME YOU ASSEMBLE OR DISASSEMBLE YOUR FIREARM AND ATTEMPT CLEANING OR MAINTENANCE.

- Before using your firearm for the first time, it should be cleaned.
- Your firearm was treated at the factory with either a preservative or oil to protect it against corrosion during shipping and storage.
- Preservative and oil should be wiped from the bore, chamber and exposed areas using a clean swab or patch before using the firearm.

CAUTION: Never disassemble your firearm beyond the instructions in the Field Stripping and Inspection sections of this manual.

- Purchase cleaning supplies from your firearms dealer that are specifically designated for your type and caliber of firearm. Many suppliers offer these in kit form for your convenience.
- Follow the instructions provided with your cleaning supplies.

NOTE: A basic firearm cleaning kit should include: a brass bore brush and a cleaning jag of appropriate size for the bore being cleaned, high-quality gun cleaning solvent and gun oil/lubricant, cotton cleaning patches and a cleaning rod that is long enough to push the brush and jag completely through the barrel.

- Remove firing residue from the bore and chamber using a properly fitted brass brush dipped in gun cleaning solvent. Finish the bore cleaning process by running a dry cotton cloth patch through the bore and chamber to remove residue and solvent.
- Clean the exterior of the firearm using a non-abrasive cleaning cloth.
- After cleaning, lightly coat the metal parts, internal and external with a high quality firearm oil.
- Whenever your firearm has been exposed to sand, dust, extreme humidity, water or other adverse conditions, it must be cleaned and lubricated.

CLEANING AND MAINTENANCE CONTINUED



WARNING: ALWAYS HAVE ADEQUATE VENTILATION. CLEANING FIREARMS IN POORLY VENTILATED AREAS, DISCHARGING FIREARMS, OR HANDLING AMMUNITION MAY RESULT IN EXPOSURE TO LEAD AND OTHER SUBSTANCES KNOWN TO CAUSE BIRTH DEFECTS, REPRODUCTIVE HARM AND OTHER SERIOUS PHYSICAL INJURY. WASH HANDS THOROUGHLY AFTER EXPOSURE.

CAUTION: Always follow the instructions provided with your firearm cleaner and firearm lubricant.

CAUTION: Some cleaners can cause damage to your firearm. You should avoid prolonged solvent immersion and prolonged ultrasonic cleaning of your firearm. Choice of solvent should be restricted to those products specifically developed for firearms maintenance. Damage to a firearm's finish may occur if these cautions are ignored. Ammoniated solvents or other strong alkaline solvents, should not be used on any Smith & Wesson firearm. Cleaning is essential to ensure the proper functioning of your firearm.

- Your firearm is a precision instrument. To ensure reliable function it is necessary to follow a routine maintenance procedure. After firing your firearm, be sure to unload it following the procedure outlined in the section entitled "Inspecting Your Firearm" before performing any cleaning or maintenance procedure.
- Remove any firearm cleaning solution, oil and fingerprints from the outside surfaces of the firearm. (Finger moisture, if left, could start a corrosion process).



WARNING: NEVER MANIPULATE, ADJUST OR CHANGE ANY OF THE INTERNAL COMPONENTS OF YOUR FIREARM UNLESS SPECIFICALLY DIRECTED TO DO SO IN THIS MANUAL. IMPROPER MANIPULATION OF ANY INTERNAL COMPONENT MAY AFFECT THE SAFETY AND RELIABILITY OF YOUR FIREARM AND MAY CAUSE SERIOUS INJURY OR DEATH.



WARNING: ANY MAINTENANCE, ADJUSTMENT OR SERVICE NOT SPECIFIED IN THIS MANUAL MAY AFFECT THE SAFETY AND RELIABILITY OF YOUR FIREARM AND MUST BE PERFORMED BY A QUALIFIED GUNSMITH USING GENUINE SMITH & WESSON PARTS. IF YOU DO OTHERWISE, IMPROPER FUNCTIONING OF YOUR FIREARM MAY OCCUR AND SERIOUS INJURY OR DEATH MAY RESULT.

- If your firearm will be used in a cold climate, be sure to use an oil of an appropriate weight so that it will not congeal in cold temperatures, causing the interaction of important parts to be slowed or halted.

CLEANING AND MAINTENANCE CONTINUED

MAINTENANCE BEFORE STORAGE

- When storing a firearm, do not encase the firearm in anything that will attract or hold moisture, for example; leather, heavy cloth or a sealed gun case or box. Also, do not store firearms with anything that blocks air movement through the barrel as this can be a contributing factor to moisture accumulation and resulting corrosion. If your firearm is to be stored for an extended period, the bore, chamber and metal surfaces should be lightly oiled with a high-quality lubricating oil or preservative intended for use on firearms.
- The bolt and barrel's bore should be lightly coated with an anti-rust oil. Before using your firearm again, be sure to clean it. Every time you clean your firearm, check it for signs of wear. If excessive wear is noted, do not use the firearm. Return it to Smith & Wesson for service or have it checked by a qualified gunsmith.

CAUTION: Use of ammunition manufactured with corrosive primers in this firearm will cause oxidation to develop on any metal parts of the firearm. To prevent such oxidation, the residue from corrosive primers must be completely removed from all metal parts after each time ammunition with corrosive primers is used in this firearm. Conventional oil or solvent-based firearm cleaners WILL NOT dissolve the residue from corrosive primers. Residue from corrosive primers MUST be completely dissolved with a water-based cleaner. After the corrosive residue has been completely dissolved from all metal parts, remove any excess water-based cleaner from the firearm. Finally, lubricate the firearm as instructed in the Safety and Instruction Manual. Failure to follow these instructions will cause damage to the firearm and may affect the ability of the firearm to function properly.

- Check with the ammunition manufacturer or a qualified gunsmith if you are unsure whether the particular ammunition you plan to use in this firearm has been manufactured with corrosive primers. If in doubt, follow all the instructions above to prevent oxidation caused by ammunition manufactured with corrosive primers.
- Ammunition manufactured by SAAMI member companies do not use corrosive primers.

LIMITED WARRANTY

For Owners Within The United States.

This warranty is granted by Smith & Wesson Inc. This warranty is effective from the date of purchase and applies to the original owner of any firearm. With respect to such firearms, this warranty supersedes any and all other warranties.

Smith & Wesson® firearms are warranted to be free from defects in material and workmanship. Any such defects of which Smith & Wesson receives written notice within one year from the date of purchase by the original owner, will be remedied by Smith & Wesson without charge within a reasonable time after such notification and delivery of the firearm as provided below.

In the event of an emergency (repairs needed by law enforcement, an upcoming match or hunting trip), call 1-800-331-0852, ext. 4125 and ask for 911 Priority Repair Service. This allows you to speak with a Smith & Wesson representative. Immediately upon receipt, your firearm will be assigned to a gunsmith. After the work is completed, we will return your Smith & Wesson firearm via overnight delivery.

Warranty claims (in writing) and the firearm concerned should be delivered to Smith & Wesson's Customer Service Department, 2100 Roosevelt Avenue, Springfield, Massachusetts 01104. In addition, a copy of the bill of sale in the owner's name, or a copy of ATF Form 4473 indicating date of purchase must be included. It is important that the owner comply with all applicable federal, state and local laws and regulations in the shipment of firearms to Smith & Wesson.

NOTE: See the Contact & Shipping section of this manual for further details regarding returns.

Warranty claims should state the model and serial number of the firearm concerned and the description of the difficulty experienced. It is recommended that shipments be insured by the owner, since Smith & Wesson will accept no responsibility for loss or damage in transit. Transportation and insurance charges for return to owner will be paid by Smith & Wesson if the claim is covered by the warranty.

UNDER NO CIRCUMSTANCES SHALL SMITH & WESSON BE RESPONSIBLE FOR INCIDENTAL OR CONSEQUENTIAL DAMAGES WITH RESPECT TO ECONOMIC LOSS, INJURY, DEATH OR PROPERTY DAMAGE, WHETHER AS A RESULT OF BREACH OF THIS WARRANTY, NEGLIGENCE OR OTHERWISE.

Some states do not allow the exclusion or limitation of incidental or consequential damages, so the above limitation or exclusion may not apply to you.

LIMITED WARRANTY CONTINUED

Smith & Wesson will not be responsible for:

- Defects or malfunctions resulting from careless handling, unauthorized adjustments or modifications made or attempted by anyone other than a qualified gunsmith following Smith & Wesson® authorized procedures, or failure to follow the disassembly instructions in the Smith & Wesson manual.
- Use of defective or improper ammunition, corrosion, neglect, abuse, ordinary wear and tear, or unreasonable use.
- Criminal misuse, negligence or use under the influence of drugs or alcohol.

Smith & Wesson's Lifetime Service Policy begins after the warranty period has expired. Smith & Wesson will repair, without charge, for the lifetime of the original owner, any Smith & Wesson® handgun purchased on or after February 1, 1989, any M&P® series rifle, and any M&P® series shotgun, that is found to have a defect in material or workmanship. Eligibility for this Lifetime Service Policy requires returning the Product Registration Card within 30 days of purchase. The Lifetime Service Policy covers functional defects; it does not include the firearm's finish, grips, magazines or sights. The Lifetime Service Policy is in addition to and not an extension of the Smith & Wesson Warranty.

This warranty gives you specific legal rights. You may also have other rights that vary from state to state.

NOTE: All liability is excluded in the event that the instructions in the Smith & Wesson manual are not observed.

CONTACT AND SHIPPING INFORMATION

For Owners Within The United States

NOTE: A Return Merchandise Authorization (**RMA**) is the first step in the process of returning a product in order to receive a repair, replacement or refund. Please contact Smith & Wesson's Customer Service Dept. (via e-mail: qa@smith-wesson.com or by phone at 1-800-331-0852 ext. 4125) to obtain authorization to return your firearm so we can process it quickly and efficiently. The RMA number that is supplied by Smith & Wesson must be displayed on the outside of the returned product's packaging; returns without an RMA number will be routed differently which will result in delayed processing.

The issuance of an Return Merchandise Authorization (**RMA**) allows Smith & Wesson an opportunity to try to diagnose and correct a customer's concerns with the product (such as ammunition problems) before it is returned. Accordingly, please contact us before returning your Smith & Wesson firearm.

CONTACT CUSTOMER SERVICE

Tel: 1-800-331-0852 • 1-413-781-8300 ext. 4125

E-mail: qa@smith-wesson.com

RETURNS - FOR SERVICE

ALL SMITH & WESSON FIREARMS

Smith & Wesson
2100 Roosevelt Avenue
Springfield, MA 01104

Should your Smith & Wesson firearm require service, it should be returned to the Smith & Wesson factory.

- Call or e-mail the Customer Service Dept. for authorization and shipping instructions.
- Ensure that the firearm is unloaded.
- **Do not attempt to ship a firearm via US Postal Service; only federally licensed dealers may ship a firearm by US Postal Service.**
- **DO NOT SHIP ANY AMMUNITION.**
- Enclose a letter which includes your full name and address (no P.O. Boxes, please), daytime telephone number, e-mail address, the serial number of the firearm, and details of the problem experienced (stating the brand and type of ammunition used when the problem occurred) or work desired.
- Record the serial number before shipping, in case you wish to check on the repair status of your firearm.

CONTACT AND SHIPPING CONTINUED

- Please remove all custom parts and accessories, such as stocks, special sights and scopes, or slings from your firearm before returning.
- Place the firearm in its original case or in a similarly secure container and pack it securely.
- The package must NOT bear any markings which indicate the identity of the contents.
- It is most important that you comply with federal, state, and local laws and regulations. The following guidelines are meant to help, but you must seek assistance from the appropriate authorities if necessary.
- If your firearm must be replaced, it may be necessary to ship the replacement to a dealer rather than directly to you. You will be requested to furnish a signed FFL (Federal Firearms License) from your dealer in such an instance.
- Warranty repair work will begin upon receipt and examination of the firearm. In the case of repairs or work not covered by the warranty, a quotation covering the cost of the work plus round trip transportation charges will be sent to you. Repairs or modification will be scheduled upon receipt of payment.



WARNING: YOU MAY PURCHASE ACCESSORIES FOR YOUR SMITH & WESSON FIREARM. YOU MUST HAVE SOME OF THESE PARTS INSTALLED BY A GUNSMITH QUALIFIED TO PERFORM SERVICE ON SMITH & WESSON FIREARMS. YOU MUST NEVER ATTEMPT TO MODIFY YOUR FIREARM OR INSTALL REPLACEMENT PARTS IN YOUR FIREARM. ALWAYS USE A QUALIFIED SMITH & WESSON GUNSMITH EVEN IF THE REPAIR SEEMS TO BE SIMPLE.

BATTERY WARNINGS



WARNING: IF A BATTERY OPERATED ACCESSORY OR ATTACHMENT (I.E. LASER, OPTICAL SIGHT OR FLASH-LIGHT, ETC.) IS SUPPLIED OR USED WITH THIS FIRE-ARM, THE FOLLOWING WARNINGS AND INSTRUCTIONS MUST BE ADHERED TO.



WARNING: KEEP BATTERIES AWAY FROM CHILDREN. THERE IS A CHEMICAL BURN HAZARD ASSOCIATED WITH BATTERIES.



WARNING: IF A NEW OR USED LITHIUM BUTTON/COIN CELL BATTERY IS SWALLOWED OR ENTERS THE BODY, IT CAN CAUSE SEVERE INTERNAL BURNS AND CAN LEAD TO DEATH IN AS LITTLE AS 2 HOURS. ALWAYS COMPLETELY SECURE THE BATTERY COMPARTMENT. IF THE BATTERY COMPARTMENT DOES NOT CLOSE SECURELY, STOP USING THE PRODUCT, REMOVE THE BATTERIES, AND KEEP IT AWAY FROM CHILDREN. IF YOU THINK BATTERIES MIGHT HAVE BEEN SWALLOWED OR PLACED INSIDE ANY PART OF THE BODY, SEEK IMMEDIATE MEDICAL ATTENTION.

- When used correctly, batteries provide a safe and dependable source of portable power. However, misuse or abuse may result in leakage, fire, or explosion.
- Batteries can explode or leak and cause burns if installed backwards, disassembled, charged, or exposed to water, fire or high temperature.
- Always take care to install your batteries correctly observing the “+” and “-” marks on the battery and the device.
- Always replace the whole set of batteries at one time, taking care not to mix old and new batteries, or batteries of different types.
- Store unused batteries in their original packaging and away from metal objects that may short-circuit them.
- Remove discharged batteries from equipment promptly to avoid possible damage from leakage.
- Never dispose of batteries in fire. (Failure to observe this precaution may result in an explosion.)
- The batteries are supplied in a charged state and are not designed for recharging. Recharging may cause leakage, fire, or explosion.
- The batteries should be disposed of properly, including keeping them away from children.
- Dispose of used batteries immediately. Even used batteries may cause injury.

USING THE STORAGE LOCK



WARNING: NEVER ATTEMPT TO INSTALL OR REMOVE A LOCK ON A LOADED FIREARM. ALWAYS ENSURE THAT THE FIREARM IS UNLOADED. FAILURE TO FOLLOW THIS WARNING COULD RESULT IN AN ACCIDENTAL DISCHARGE CAUSING INJURY AND/OR DEATH TO THE SHOOTER OR BYSTANDERS AND DAMAGE TO PROPERTY.



WARNING: NEVER LOCK A LOADED FIREARM AND NEVER LOAD A LOCKED FIREARM.



WARNING: ALWAYS STORE YOUR FIREARM AND AMMUNITION SEPARATELY SO THAT THEY ARE NOT ACCESSIBLE TO CHILDREN OR OTHER UNAUTHORIZED PERSONS. SAFE AND SECURE STORAGE OF YOUR FIREARM AND AMMUNITION ARE YOUR RESPONSIBILITY. IT IS A FULL-TIME RESPONSIBILITY.



WARNING: YOUR FIREARM IS YOUR RESPONSIBILITY. YOU MUST PREVENT YOUR FIREARM FROM BEING STOLEN OR FROM BEING USED BY UNTRAINED OR UNQUALIFIED INDIVIDUALS. KEEP IT LOCKED, UNLOADED AND SECURED WHEN NOT IN USE.

- To install the supplied cable lock on the M&P®12 shotgun, rotate the safety selector lever to the SAFE position.
- If the M&P®12 shotgun is loaded, follow the unloading procedure on page 24 of this manual.
- While keeping the firearm's muzzle pointed in a safe direction, open the action by pressing the action lock lever button down and pulling the vertical foregrip fully rearward.
- 1) Depress the reciprocating cover release button and 2) pull the reciprocating cover as far rearward as it will travel, approximately 1¾ inches (FIGURE 75).

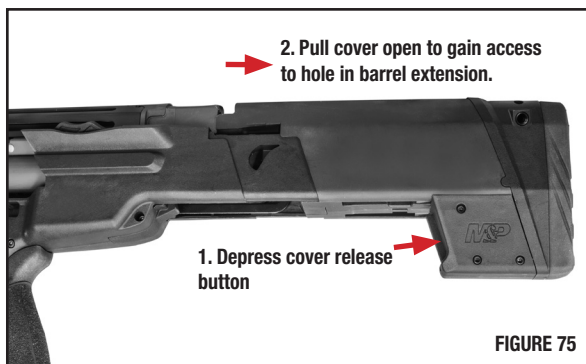

USING THE STORAGE LOCK CONT'D

- The M&P®12 shotgun ships with a cable/padlock in the box from the factory.
- Unlock the cable from the padlock and slide the small end down through the hole in the barrel extension (FIGURE 76) and out through the ejection port. Then close the lock and remove the key.

Shown with cable lock in place through barrel extension and out ejection port

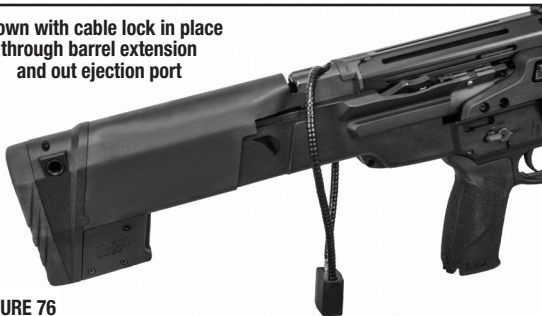

FIGURE 76

- Never leave the key with the stored firearm.

PATENT INFORMATION

- This product may be covered by one or more patents.
Visit www.smith-wesson.com for virtual patent information.



3013381

Smith & Wesson®

2100 Roosevelt Avenue • Springfield, MA 01104

www.smith-wesson.com

p/n 3013381

REV:M&P12-091520