

# KRISS®

## OWNER'S MANUAL



<b>VECTOR GEN II</b>	SDP	SDP SB
	SBR	CRB

**Read the instructions and warnings in this manual carefully before using this firearm; do not discard this manual.**

This instruction manual should always accompany this firearm and be transferred with it upon ownership, or when the firearm is loaned or presented to another person.

# TABLE OF CONTENTS

---

Firearm Safety Rules .....	2
Package Contents .....	2
Main Features .....	3
Specifications .....	4
Handling and Operation .....	6
1. Ammunition .....	6
2. Loading the Magazine .....	6
3. Loading the Firearm.....	7
4. Shooting.....	8
5. Bolt Lock .....	8
6. Charging .....	9
7. Unloading and Clearing .....	10
8. Sight Adjustment.....	11
9. DEFIANCE® Stock .....	12
Maintenance .....	12
1. Disassembly .....	12
2. Cleaning and Inspection .....	14
a. Bolt .....	14
b. Slider .....	15
c. Barrel Assembly .....	15
d. Break Down Pins .....	15
e. Upper Housing .....	16
f. Lower Housing .....	16
f. Barrel .....	17
3. Lubrication .....	17
a. Upper Housing/FCG .....	17
b. Lower Housing/FCG .....	18
4. Assembly.....	18
5. Function Check.....	19
Troubleshooting .....	20
Lock, Storage, and Transportation .....	22
Components Diagram and List.....	23

# FIREARM SAFETY RULES

---



## SAFETY IS YOUR RESPONSIBILITY.

Below are some general guidelines you should follow closely when operating firearms or are in the company of those who are.

- Always treat your firearm as if it is loaded.
- Never point a firearm at anything you are not willing to destroy.
- Keep your finger off the trigger until you are ready to shoot.
- Always keep your firearm on safe until you intend to fire.
- Always keep your firearm unloaded until you intend to use it.
- Always know your target and what may lie behind it.
- Always become thoroughly familiar with your firearm before using it.
- Use only new, factory manufactured ammunition in your KRISS Vector that is the correct caliber and is SAAMI and/or C.I.P. approved.
- Always wear proper eye and ear protection when you are around firearms.
- Be aware that certain types of firearms and firing situations require additional safety considerations.

## PACKAGE CONTENTS

---

- [1] KRISS VECTOR SDP / SDP SB / SBR / CRB / CRB Featureless
- [1] Magazine
- [1] Owner's manual
- [1] Cleaning kit
- [1] Cable lock

# MAIN FEATURES

## VECTOR SBR

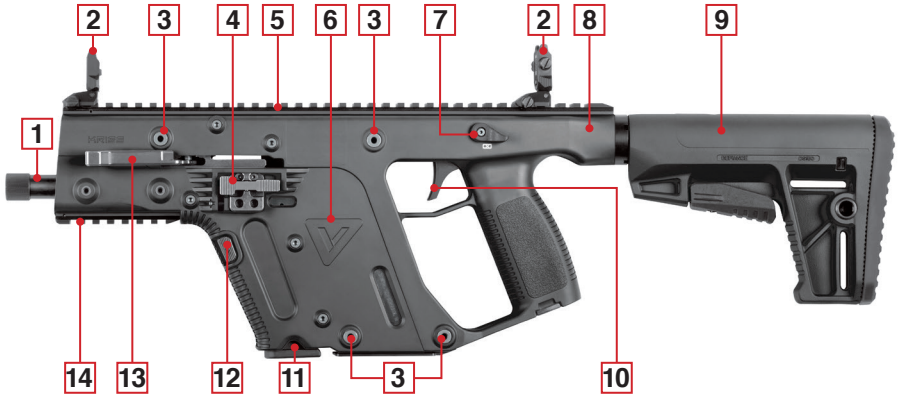

## VECTOR CRB



## VECTOR CRB (Featureless)



## VECTOR SDP



## VECTOR SDP SB



# MAIN FEATURES

- |  |  |
|--|--|
| 1: 5.5in / 140mm barrel                                    | 11: Glock magazine compatible              |
| 2: DEFIANCE® flip sights                                   | 12: Magazine release button                |
| 3: 4-pin toolless disassembly                              | 13: Charging handle / brass check function |
| 4: Bolt release / catch                                    | 14: MIL-STD 1913 Picatinny bottom rail     |
| 5: Full length MIL-STD 1913 Picatinny top rail             | 15: KRISS Vector enhanced shroud           |
| 6: Patented KRISS Super V Recoil Mitigation System         | 16: DEFIANCE® DS150 Stock (Fixed)          |
| 7: Ambidextrous short throw safety lever                   | 17: Hand Stop                              |
| 8: Integrated M4 buffer tube adaptor                       | 18: Rail Cover                             |
| 9: DEFIANCE® DS150 Stock                                   | 19: Spetz Gear paddle                      |
| 10: Smooth pivoting trigger with audible and tactile reset | 20: Quick detach (QD) sling swivel         |
|  | 21: Stabilizing Brace                      |

"Glock®" is a registered trademark of Glock Health, Science and Research GmbH LLC Austria. KRISS USA is not affiliated in any manner with, or otherwise endorsed by, Glock. The use of "Glock®" is merely to reference compatibility.

# SPECIFICATIONS

Model	CRB			
Operating system	Closed bolt, delayed-blowback patented KSV System			
Caliber	.45 ACP	9mm	10mm	40S&W
Overall length	Extended: 38.2 in / 971 mm		Collapsed: 35 in / 888 mm	
Overall length (Featureless model)	36.4 in / 924 mm			
Overall height	6.8 in / 175 mm			
Weight (unloaded)	8 lbs / 3.6 kg			
Weight (Featureless model unloaded)	8.7 lbs / 3.9 kg			
Barrel length	16 in / 406 mm			
Barrel twist	1:16" RH	1:10" RH	1:10" RH	1:10" RH
Frame material	Advanced metal and polymer composite components			
Capacity	13+1	17+1	15+1	15+1
Capacity (Featureless model)	10+1			
Optional magazines (Not available for Featureless model)	G21 10 rd KRISS MagEx 25 rd	G17 10 rd G17 33 rd	G20 10 rd G20 15 rd	G22 10 rd G22 15 rd

# SPECIFICATIONS

Model	SBR			
Operating system	Closed bolt, delayed-blowback patented KSV System			
Caliber	.45 ACP	9mm	10mm	40S&W
Thread pitch	M16x1 LH	1/2x28 RH	9/16x24 RH	9/16x24 RH
Overall length	Extended: 27.5 in / 698 mm Collapsed: 24 in / 610 mm			
Overall height	6.8 in / 175 mm			
Weight (unloaded)	7 lbs / 3.1 kg			
Barrel length	5.5 in / 140 mm			
Barrel twist	1:16" RH	1:10" RH	1:10" RH	1:10" RH
Frame material	Advanced metal and polymer composite components			
Capacity	13+1	17+1	15+1	15+1
Optional magazines	G21 13 rds KRISS MagEx 25 rds	G17 17 rds G17 33 rds	G20 10 rds G20 15 rds	G22 15 rds

Model	SDP			
Operating system	Closed bolt, delayed-blowback patented KSV System			
Caliber	.45 ACP	9mm	10mm	40S&W
Thread pitch	M16x1 LH	1/2x28 RH	9/16x24 RH	9/16x24 RH
Overall length	16.75 in / 425 mm			
Overall height	6.8 in / 175 mm			
Weight (unloaded)	5.9 lbs / 2.7 kg			
Barrel length	5.5 in / 140 mm			
Barrel twist	1:16" RH	1:10" RH	1:10" RH	1:10" RH
Frame material	Advanced metal and polymer composite components			
Capacity	13+1	17+1	15+1	15+1
Optional magazines	G21 13 rds KRISS MagEx 25 rds	G17 17 rds G17 33 rds	G20 10 rds G20 15 rds	G22 15 rds

Model	SDP SB			
Operating system	Closed bolt, delayed-blowback patented KSV System			
Caliber	.45 ACP	9mm	10mm	40S&W
Thread pitch	M16x1 LH	1/2x28 RH	9/16x24 RH	9/16x24 RH
Overall length	24.25 in / 616 mm			
Overall height	6.8 in / 175 mm			
Weight (unloaded)	6.7 lbs / 3 kg			
Barrel length	5.5 in / 140 mm			
Barrel twist	1:16" RH	1:10" RH	1:10" RH	1:10" RH
Frame material	Advanced metal and polymer composite components			
Capacity	13+1	17+1	15+1	15+1
Optional magazines	G21 13 rds KRISS MagEx 25 rds	G17 17 rds G17 33 rds	G20 10 rds G20 15 rds	G22 15 rds

# HANDLING AND OPERATION

---

## Ammunition

---

Use only new, factory manufactured ammunition in your KRISS Vector that is the correct caliber and is SAAMI and/or C.I.P. approved.

Ensure that your ammunition is free of defects, dirt, debris, lubrication, or anything that may cause malfunctions.



**DO NOT use re-manufactured ammunition. Use of re-manufactured ammunition WILL void your warranty and may result in severe bodily injury and severe damage to your firearm.**

## Loading the Magazine

---



**Be sure to use the appropriate caliber of ammunition and original Glock magazine for your KRISS Vector. Failure to utilize the correct ammunition and original Glock magazine may result in a malfunction and could cause severe injury and/or death.**

1. With the bullet facing the front of the magazine, insert the rim of the case down into the follower.
2. Push the round to the rear of the magazine, underneath the magazine lips.
3. Repeat until the magazine is fully loaded.

NOTE: Where permitted by law, KRISS has developed an optional extended 25 round .45 ACP magazine in both kit and fully assembled form. See your KRISS dealer or [www.kriss-usa.com](http://www.kriss-usa.com) for more details.

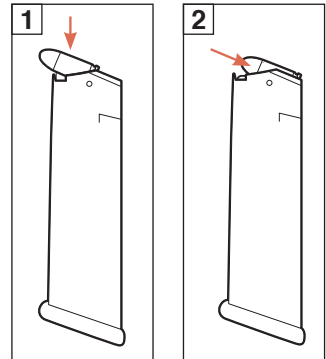

# HANDLING AND OPERATION

## Loading the Firearm



Ensure the firearm is placed on safe and pointed in a safe direction with your finger off the trigger.

**NOTE:** Always load the KRISS Vector with the bolt open.

1. Pull the charging handle back and press the bolt catch to lock the bolt open.
2. Place the magazine into the magazine well with the bullet head facing forward. Tap the magazine to ensure that it is securely in position and seated properly.
3. Release bolt to chamber a round.

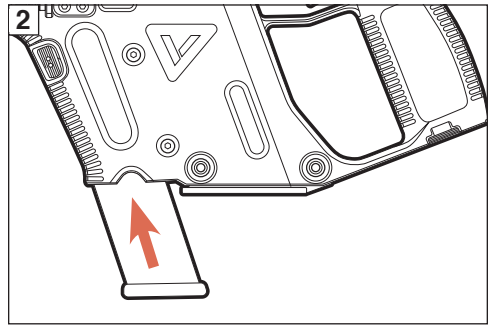
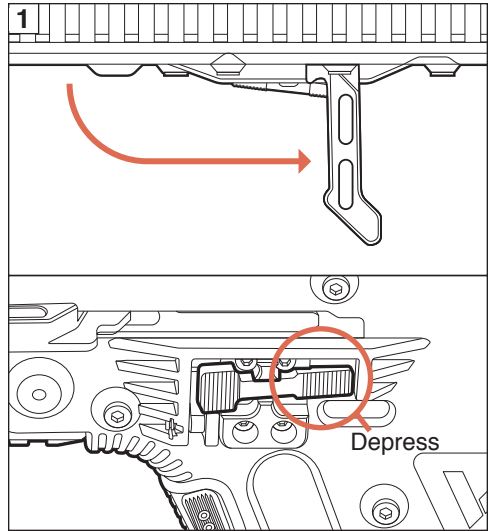



# HANDLING AND OPERATION

## Shooting



**ALWAYS** point the firearm in a safe direction.  
**ALWAYS** load the KRISS Vector with the bolt open.

1. Insert a loaded magazine, ensuring it positively locks into place. Depress the bolt release to chamber a round.
2. Aim the firearm at the desired target and take the firearm off safe.
3. Pull trigger rearward to fire.
4. Once firing has been completed, take your finger off the trigger and place the firearm back into safe.

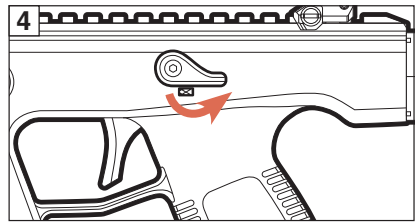
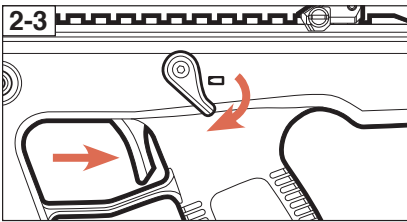
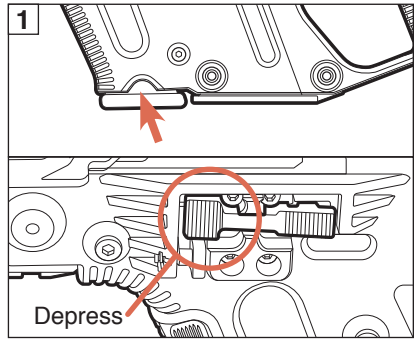

## Bolt Lock

When the magazine is fired until empty, the bolt will be engaged by the bolt catch, holding the bolt back in the retracted position.

### To continue firing

1. Replace the empty magazine with a loaded magazine.
2. Press the bolt release button to load the firearm.

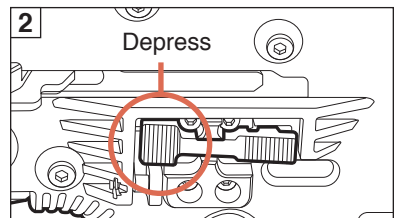
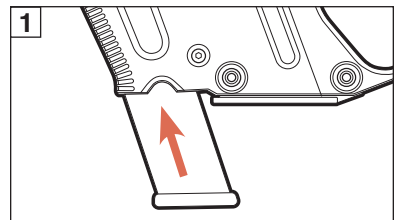

# HANDLING AND OPERATION

## Bolt Lock

### When firing is complete

1. Remove the magazine and press the bolt release to close the bolt.
2. Set firearm to safe.

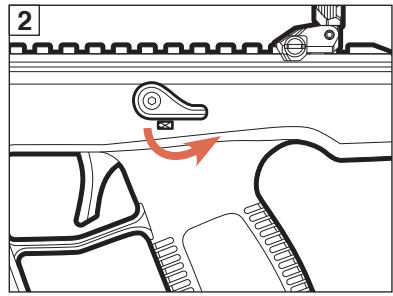
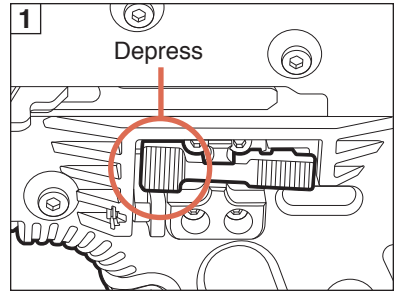

## Charging

1. Rotate the charging handle 90 degrees.
2. Grip the charging handle as close to the housing as possible, firmly pull the charging handle straight back.
3. Release the charging handle from its most rearward position.

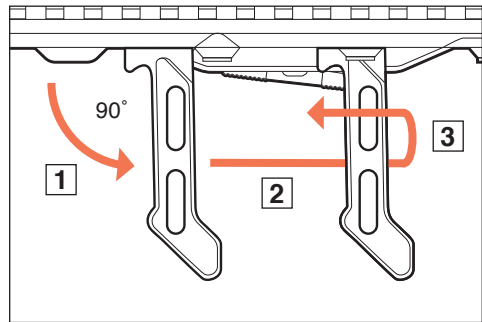

**Do not ease the charging handle forward, doing so can prevent the bolt from seating properly.**

# HANDLING AND OPERATION

## Unloading and Clearing

**NOTE:** When finished firing, ALWAYS place your finger outside the trigger guard with the barrel maintained in safe direction and activate the safety.

1. Switch the firearm to the safe position.
2. Press the magazine release to remove the magazine.
3. Rotate the charging handle 90 degrees. With two fingers as close to the housing as possible, pull the charging handle straight back, firmly, and lock the bolt back.
4. Visually inspect that there is no magazine inserted, and the chamber is clear of any ammunition.
5. Remove all ammunition from the magazine.

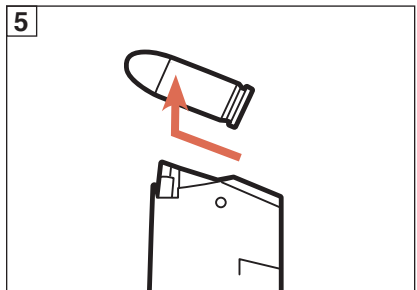
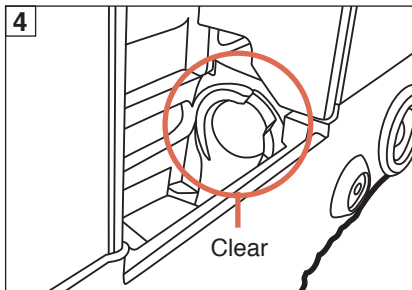
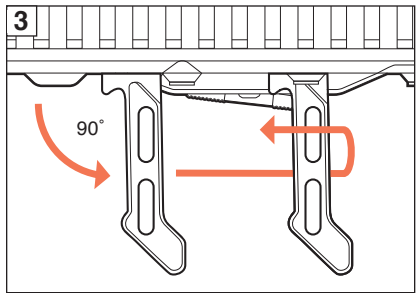
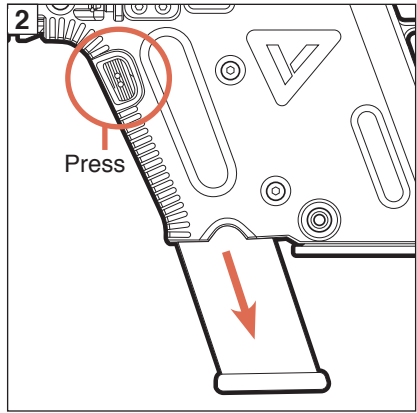
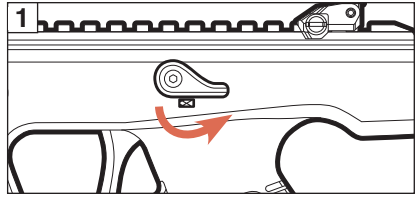

# HANDLING AND OPERATION

## Sight Adjustment

### Front sight

1. Flip up to deploy the front sight. Flip down to stow the front sight in the lowered position.
2. Turn the adjustment dial to move the front sight post. Turn the dial clockwise to lower the point of impact. Turn the dial counter-clockwise to raise the point of impact.

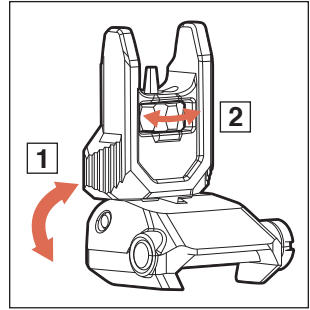

### Rear sight

1. Flip up to to deploy the rear sight. Flip down to stow the rear sight in the lowered position.
2. Turn the adjustment knob to move the aperture. Turn the knob clockwise (indicated with an “R” and an arrow on surface of the knob) to move point of impact to the right. Turn the knob counter-clockwise to move point of impact to the left.

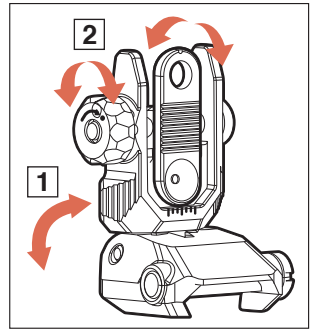

# HANDLING AND OPERATION

## DEFIANCE® DS150 Stock

Press the stock adjustment latch to slide the stock into the desired position.

**NOTE:** The DS150 stocks on CA and NJ Vector CRB models are fixed for compliance in each individual state.

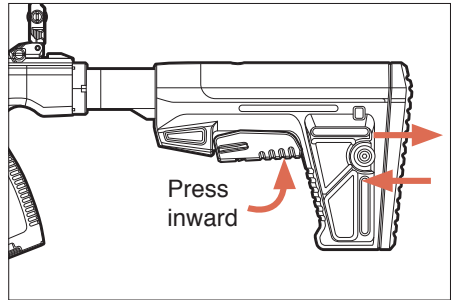

## MAINTENANCE

### Disassembly



**Check to ensure that the magazine has been removed and that chamber is cleared. (See Unloading and Clearing section)**

1. Pull the Charging handle back to reset the hammer. **Ensure the bolt is in battery prior to step 2.**
2. Remove the first 3 break down pins

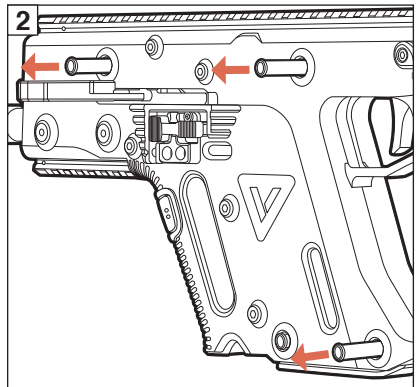
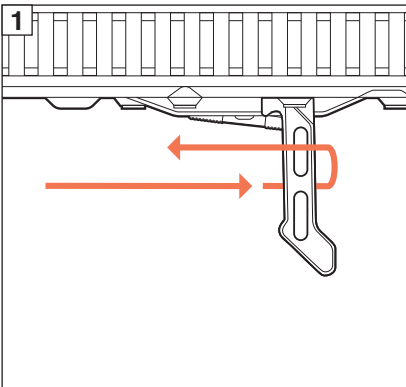

**Do not release the hammer when the upper receiver has been separated from the lower, doing so could cause damage to the ejection port.**

# MAINTENANCE

## Disassembly

3. Separate the housings by pulling straight up on the upper receiver and down on the lower receiver.

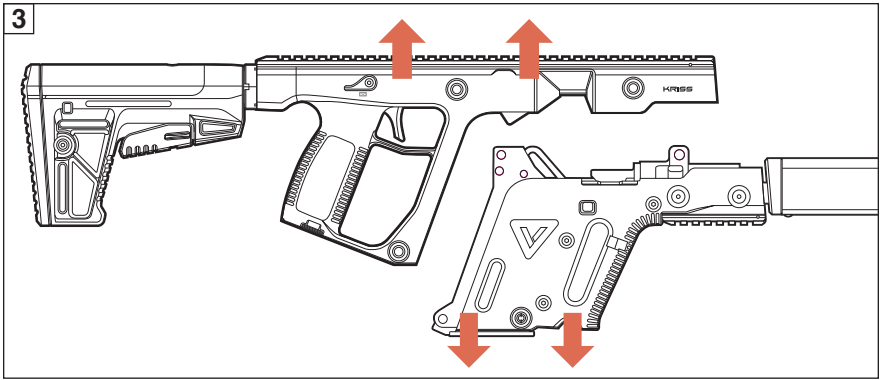

4. Rotate the lower receiver upside down and remove the final 4th pin.
5. Pull on the bolt assembly up and out of the receiver.
6. Rotate the bolt to remove slider assembly.

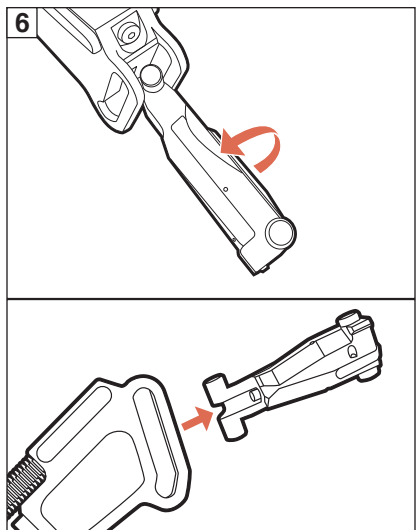
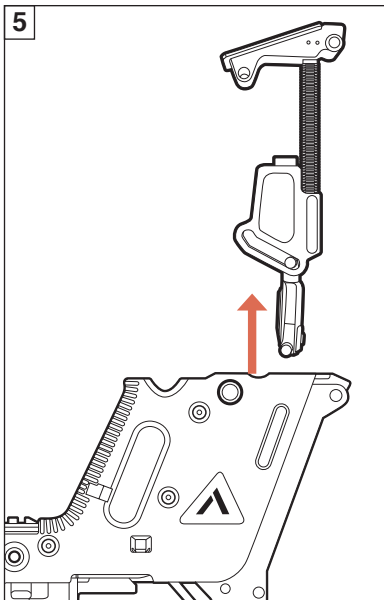
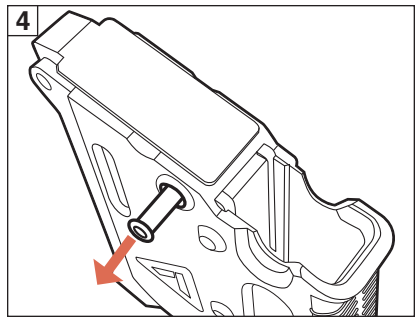

# MAINTENANCE

## Cleaning and Inspection

Your KRISS Vector is like any other firearm in that it requires routine cleaning and lubrication maintenance every time you fire it. Every time you clean, always inspect for wear and damage and always clean and inspect if your firearm was stored for a long period of time

Depending upon the ammunition used and the conditions which you shoot, we recommend to wipe down the bolt and slider raceways with a lint-free cloth and lightly lubricate every 400 rounds. The more dusty and humid the environment, the more frequent the cleaning requirement. We recommend a complete teardown, cleaning and inspection at least every 1000 rounds.



**ALWAYS make sure your firearm is cleared before attempting any cleaning or maintenance.**

### BOLT

Ensure the bolt face is clean and free of carbon build-up. Be especially careful to inspect and remove any build-up under the extractor.

A. Fouling or build-up of carbon under the extractor may lead to poor extraction and poor chambering. Ensure the extractor has no cracks or chips and that the extractor pivot pin has not drifted from its hole. Ensure that the extractor spring tension has not weakened. Check by pushing up on the forward (bolt face) end of the extractor with your thumb; it should only move slightly and require considerable force to move it at all.

B. Inspect the bolt face to ensure there is no scoring or other damage and that the area surrounding the firing pin channel is clear of build-up.

C. Operate the firing pin by pushing it from the rear (Q-tip suggested) to ensure it moves freely and easily. Very little pressure will be required. Inspect the tip of the pin to ensure it is clear of build-up and not deformed in any way.

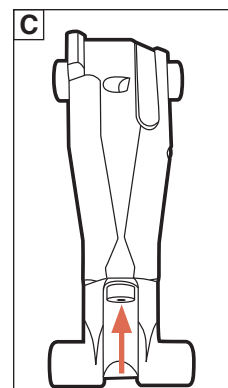
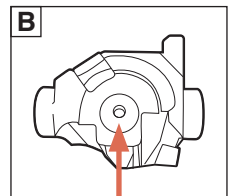
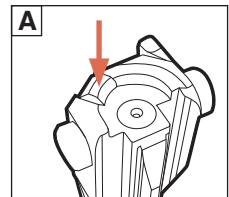

# MAINTENANCE

## Cleaning and Inspection

### SLIDER

- A. Ensure the retaining screw at the top of the spring guide rod is tight.
- B. Inspect the slider to ensure there are no cracks in the bolt retaining rails.
- C. Inspect the buffer to ensure there is no excessive wear and tear.

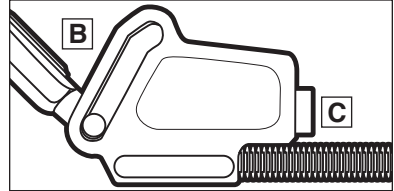
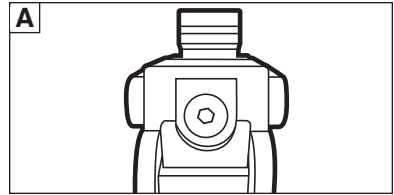

### BARREL ASSEMBLY (Carbine model)

There is no maintenance required for the barrel shroud or the outside of the barrel covered by the shroud. Should you wish to remove the shroud, use a 2.0mm Allen Key to loosen the set screw on the underside of the barrel. Carefully slide the shroud from the barrel being careful not to tear the rubber O-ring at the muzzle end. To prevent tearing, it is a good idea to lightly lubricate this O-ring when reinstalling.

**NOTE:** The barrel set screw has Loctite applied from the factory. Will require heat to remove.

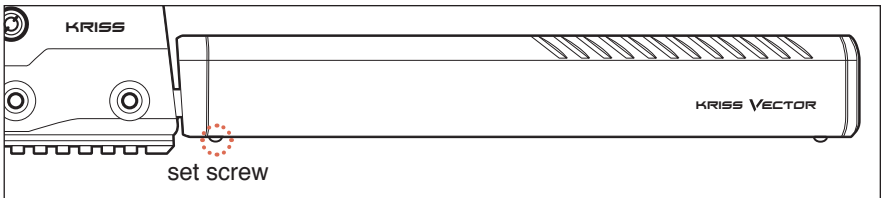

**Clean the threads of the set screw, align the screw with the dimple on the barrel and use 1-2 drops of Loctite Red 263 when re-tightening the set screw. Always ensure this set screw is tight before firing!**

### BREAK DOWN PINS

Inspect the four break down pins to ensure they are undamaged. Clean each pin, paying particular attention to those you use to secure the lower housing and receiver as these retain the operating mechanism.

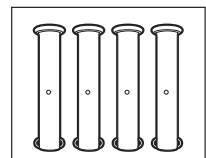



# MAINTENANCE

## Cleaning and Inspection

### UPPER HOUSING

To clean the upper housing, wipe it down using patches or a lint-free cloth. Use a Q-Tip and/or a nylon bristle brush to reach and clean the Fire Control Group (FCG).

Other upper housing items to inspect:

- A. Ejection port mounting screws: Make sure screws are tight.
- B. Ambidextrous F/S lever mounting screws: Make sure screws are tight and there is a positive click as the lever is switched back and forth.
- C. FCG and frame: Make sure FCG and frame is tight in the housing and debris-free.

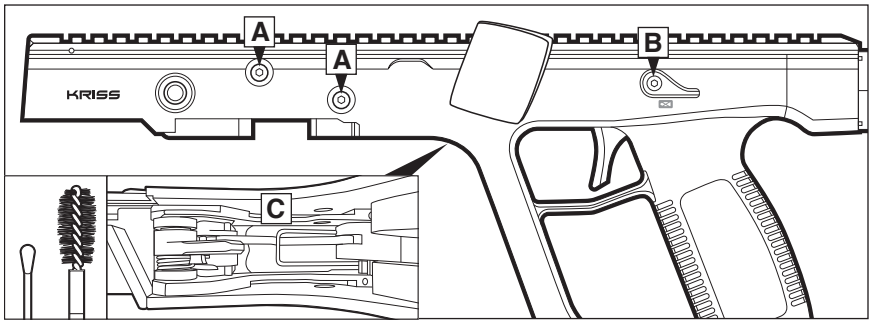

**WARNING** Do not attempt to remove the FCG; there are no owner serviceable aspects to this assembly.

### LOWER HOUSING

Clean the lower housing as you would clean the upper housing.

Other lower housing items to inspect:

- A. Housing screws: Make sure screws are tight.
- B. Bolt catch/release lever mounting block screws: Make sure screws are tight.
- C. Charging handle: Make sure handle moves freely and its two return springs are intact and clean.
- D. Mag release button: Make sure button moves freely and area underneath is clear.
- E. Ejector: Make sure ejector is not loose or bent.

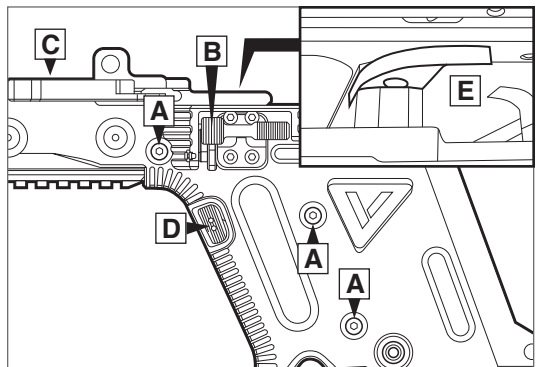

# MAINTENANCE

## Cleaning and Inspection

### BARREL

1. Insert cotton patch into eyelet attached to the bore cable in the cleaning kit and add firearms solvent (not included).
2. Feed the cable into the chamber and pull completely through the front of the barrel. Repeat 2-3 times using a newly saturated cotton swab each time.
3. Replace eyelet adaptor for brush adaptor. Feed the cable into the chamber and pull completely through the front of the barrel. Repeat 2-3 times.
4. Repeat Step 2 to clean up any fowling that was loosened by the brush.

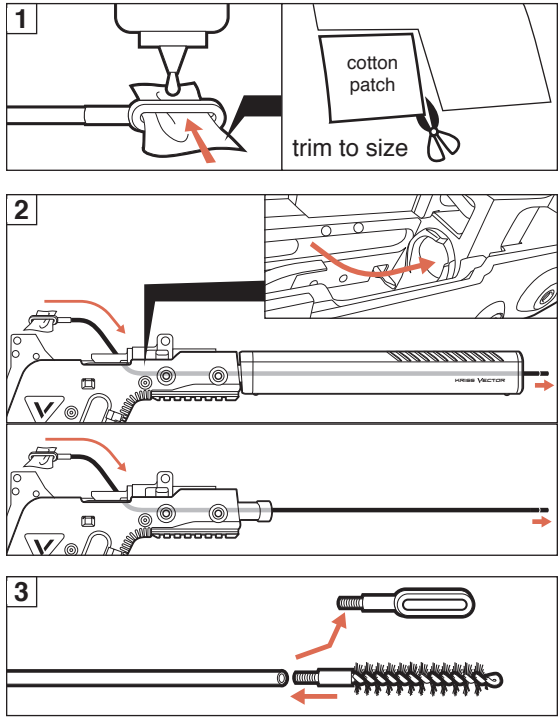

### Lubrication

The key to long life and proper function of your firearm is the use of quality lubricant. As with any firearm, it is recommended that all metal parts be lightly lubricated before reassembly or storage in order to prevent corrosion.

### Upper Housing/FCG:



**DO NOT** remove the FCG from the Upper Housing.  
**DO NOT** release the hammer when the upper receiver has been separated from the lower, doing so could cause damage to the ejection port.

- A. Place two drops of oil on the hammer and hammer pivot pin.
- B. Add one drop on the trigger pivot pin and operate the trigger and hammer several times so that the oil works its way into the moving parts of the FCG assembly.

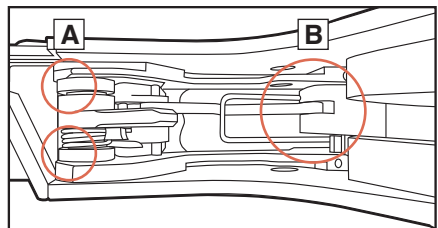

# MAINTENANCE

## Lubrication

### Lower Housing/FCG:

Lubricate as noted in the areas circled below:

- A. 2-3 drops in the left and right slider raceways.
- B. Thin coat of oil on the bolt lugs and slider bolt raceway figure, 1 drop of oil on the extractor pivot pin.
- C. 2 drops on the charging handle assembly cycle the action to ensure proper coverage.

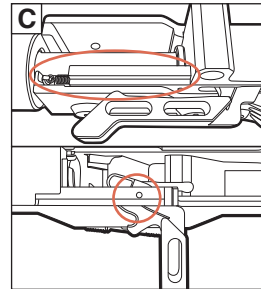
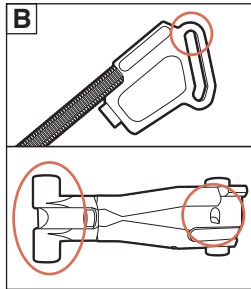
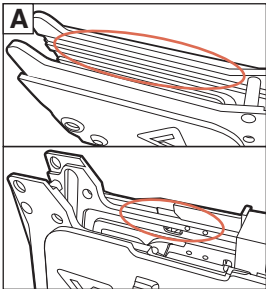

## Assembly



Ensure the bolt is oriented correctly and the bolt and slider assembly is properly assembled before installing into the lower receiver.

1. Rotate the bolt back into the bolt carrier.

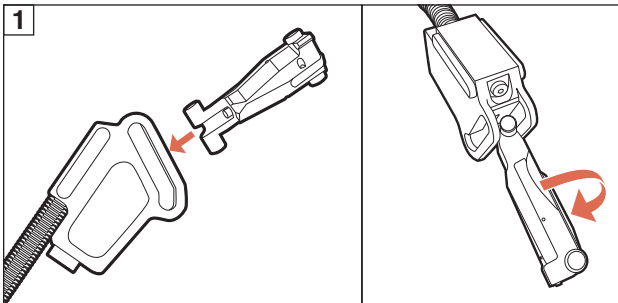

# MAINTENANCE

## Assembly

2. With the lower receiver upside down, slide the bolt lugs into the forward channel and the slider rails into the rearmost channel. Slide the entire assembly into position and secure with a break down pin.
3. Ensure that the hammer is locked back, then mate the upper receiver to the lower receiver. Replace the break down pins to secure the firearm.
4. With the firearm pointed in a safe direction, perform a function check (see page 18) and test to ensure proper operation of the firearm.

**NOTE: KRISS Vector assembly instruction video can be found at: [www.youtube.com/krissarms](http://www.youtube.com/krissarms)**

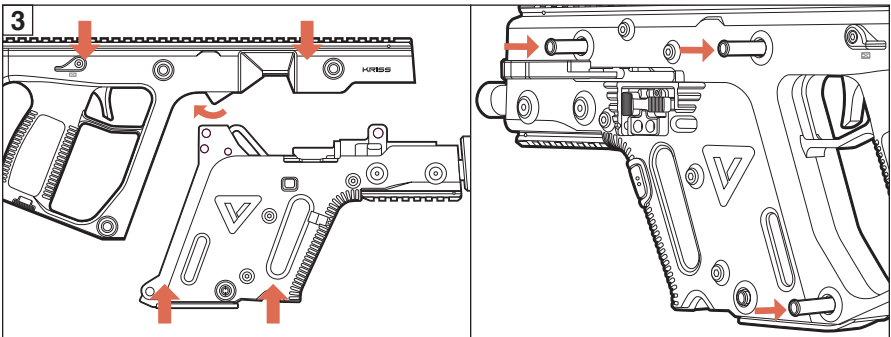
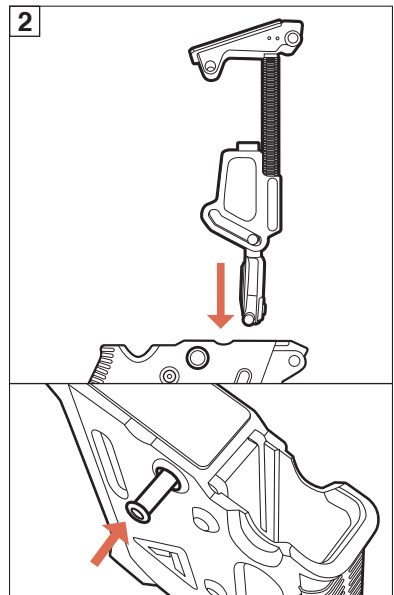

## Function check

To perform a function check, ensure the magazine is removed and that the firearm is clear and unloaded. Pull back on the charging handle with the firearm pointed in a safe direction and with an empty chamber, pull the trigger to release the hammer. An audible sound of the hammer releasing and striking the firing pin should be heard.

In order to check the trigger reset, continue to hold down the trigger after the hammer has struck the firing pin. While holding the trigger down, charge the gun again and slowly release the trigger. There should be an audible click when the trigger resets. Repeat this step once more.

Finally, check that the Safety is operational. Place the gun on safe and attempt to pull the trigger. The Trigger should be locked and the hammer should not fall.

# TROUBLE SHOOTING

The KRISS Vector has been designed to exacting standards and specifications to provide you with years of trouble free operation if properly cleaned, lubricated and inspected. However, if you experience a problem, please refer to the suggestions below. If the problem persists, please contact your local KRISS Certified Dealer or contact KRISS USA at 1.855.KRISS.US (574.7787).

Fault and defect	
<p><b>Stoppage</b>                      Stoppages and malfunctions may occur for many reasons, or combination of reasons. Should a stoppage or malfunction occur when you are firing, immediately cease firing, place the firearm on safe, unload the firarm and remove the magazine. Diagnose the problem before attempting to fire again. Some common causes for most stoppages and maulfuctions are:</p>	
Possible cause	Solution
<p><b>Bolt not fully seated forward:</b></p>	<p>This stoppage can be caused by something as simple as dirty ammo or operating action, or by easing the bolt forward by hand. Immediately:</p> <ol style="list-style-type: none"> <li>1. Safe the firearm and point in a safe direction.</li> <li>2. Check the chamber to ensure no double feed has occurred. Remove the magazine and lock the bolt back if you see any fouled rounds. Clear any fouled rounds from the chamber. Reinsert the magazine or replace magazine if necessary.</li> <li>3. Charge the firearm to chamber a new round by operating the charging lever or releasing the bolt.</li> <li>4. Switch the firearm to fire, aim down range and attempt to fire.</li> </ol>
<p><b>Double feed:</b></p>	<p>This stoppage can be caused by a fouled chamber, a bad magazine or dirty ammunition. Anytime two rounds enter the feed ramp or chamber, immediately:</p> <ol style="list-style-type: none"> <li>1. Safe the firearm and point it in a safe direction.</li> <li>2. Lock the bolt back and remove the magazine.</li> <li>3. Clear the fouled rounds.</li> <li>4. Check the magazine to ensure rounds are properly seated and are clean.</li> <li>5. Reinsert the magazine, release the bolt, switch the firearm off safe, and attempt to fire.</li> </ol>
<p><b>Reduced audible firing sound, smoke from the chamber or reduced recoil (squib round)</b></p> <p><b>Warning: Immediately cease firing should you experience any reduced audible report, reduced recoil or unusual smoking from the chamber when firing.</b></p>	<p>You may have a “squib” round situation in which a round does not fire completely due to a lack of propellant burn and the round may be lodged in the barrel causing a dangerous obstruction that, should another round be fired, may damage the firearm severely and cause potentially severe injury or death to the operator. Immediately:</p> <ol style="list-style-type: none"> <li>1. Safe the firearm and point it in a safe direction</li> <li>2. Remove the magazine and eject or clear any remaining round from the chamber</li> <li>3. Disassemble the firearm as instructed in the disassembly section.</li> <li>4. Visually inspect the barrel from the chamber end and run a cleaning rod through the barrel to ensure that there is no bullet stuck in the bore. If you find a bullet in the bore, take the firearm to your KRISS dealer to have it removed and inspected professionally. You may damage the barrel if you attempt to remove the bullet from the barrel yourself. Do not attempt to fire until the firearm has been thoroughly and professionally inspected.</li> </ol>

# TROUBLE SHOOTING

## Other common problems/causes

Fault and defect	Possible causes
<b>Will not fire</b>	<ul style="list-style-type: none"> <li>i. Firearm is switched to safe</li> <li>ii. Fouled firing pin</li> <li>iii. Trigger failure to reset</li> <li>iv. Defective ammunition</li> </ul>
<b>Bolt failure to seat</b>	<ul style="list-style-type: none"> <li>i. Dirty bolt face</li> <li>ii. Dirty ammunition fouled chamber</li> <li>iii. Weak or failed mainspring</li> <li>iv. Easing the bolt forward by hand</li> </ul>
<b>Failure to feed or double feed</b>	<ul style="list-style-type: none"> <li>i. Dirty, defective or unapproved ammunition fouled chamber</li> <li>ii. Fouled bolt face/extractor</li> <li>iii. Weak or failed mainspring</li> <li>iv. Dirty or fouled bolt/slider assembly and raceways</li> <li>v. Magazine dirty, defective or failed to seat properly</li> <li>vi. Easing the bolt forward by hand</li> </ul>
<b>Failure to eject/extract (stovepipe)</b>	<ul style="list-style-type: none"> <li>i. Broken, chipped, worn, or fouled extractor or ejector</li> <li>ii. Weak extractor spring</li> <li>iii. Obstruction in ejection port</li> <li>iv. Dirty, defective or unapproved ammunition</li> </ul>
<b>Bolt fails to lock after last round fired</b>	<ul style="list-style-type: none"> <li>i. Fouled, bent, broken or loose bolt catch or bolt lock trigger/ lever</li> <li>ii. Faulty or improperly seated magazine</li> <li>iii. Dirty, fouled or damage magazine</li> </ul>
<b>F/S selector binds</b>	<ul style="list-style-type: none"> <li>i. Fouled trigger mechanism</li> <li>ii. Poorly lubricated F/S selector mechanism</li> </ul>
<b>Magazine Fails to seat/remain in firearm</b>	<ul style="list-style-type: none"> <li>i. Not fully seated; push firmly</li> <li>ii. Faulty or worn magazine</li> <li>iii. Non-GLOCK magazine used</li> <li>iv. Worn magazine release button, catch or spring</li> <li>v. *note lock bolt to rear prior to inserting magazine*</li> </ul>
<b>Trigger Failure to reset</b>	<ul style="list-style-type: none"> <li>i. Weak primary sear return spring</li> <li>ii. Dirty or fouled trigger mechanism or FCG</li> <li>iii. Damaged or broken hammer spring</li> </ul>

# LOCK, STORAGE, AND TRANSPORTATION

---

## Lock

---

The KRISS Vector comes equipped with a custom cable lock that will satisfy all requirements for locking a firearm safely. Use of this lock does not override the requirement to always observe firearm safety procedures. However, it is your responsibility to know and comply with any State or Local regulations and restrictions that may affect how firearms must be stored where you live. KRISS USA recommends to always store your firearm unloaded, preferably locked and safe.

## Storage

---

**ALWAYS** clean and lubricate your KRISS Vector before storing it for any length of time in order to prevent corrosion (see Maintenance section). Thoroughly inspect your firearm after removing it from storage and before firing it. Corrosion can impair functionality of important safety features and create a safety risk if you fail to inspect, re-clean and re-lubricate your firearm before firing.

## Transportation

---

Transporting a firearm covers a wide and often confusing variety of Federal, State, and Local laws covering what you can and cannot do while traveling with your firearm. We believe the following websites can assist you in learning what the Federal requirements and restrictions are. For your State and Local regulations, we suggest you check with your local LE unit and your local KRISS Certified Dealer for assistance.

<http://www.tsa.gov/>

<http://www.tsa.gov/traveler-information>

<http://www.atf.gov/>

<http://www.atf.gov/content/firearms>

# COMPONENTS DIAGRAM : VECTOR CRB

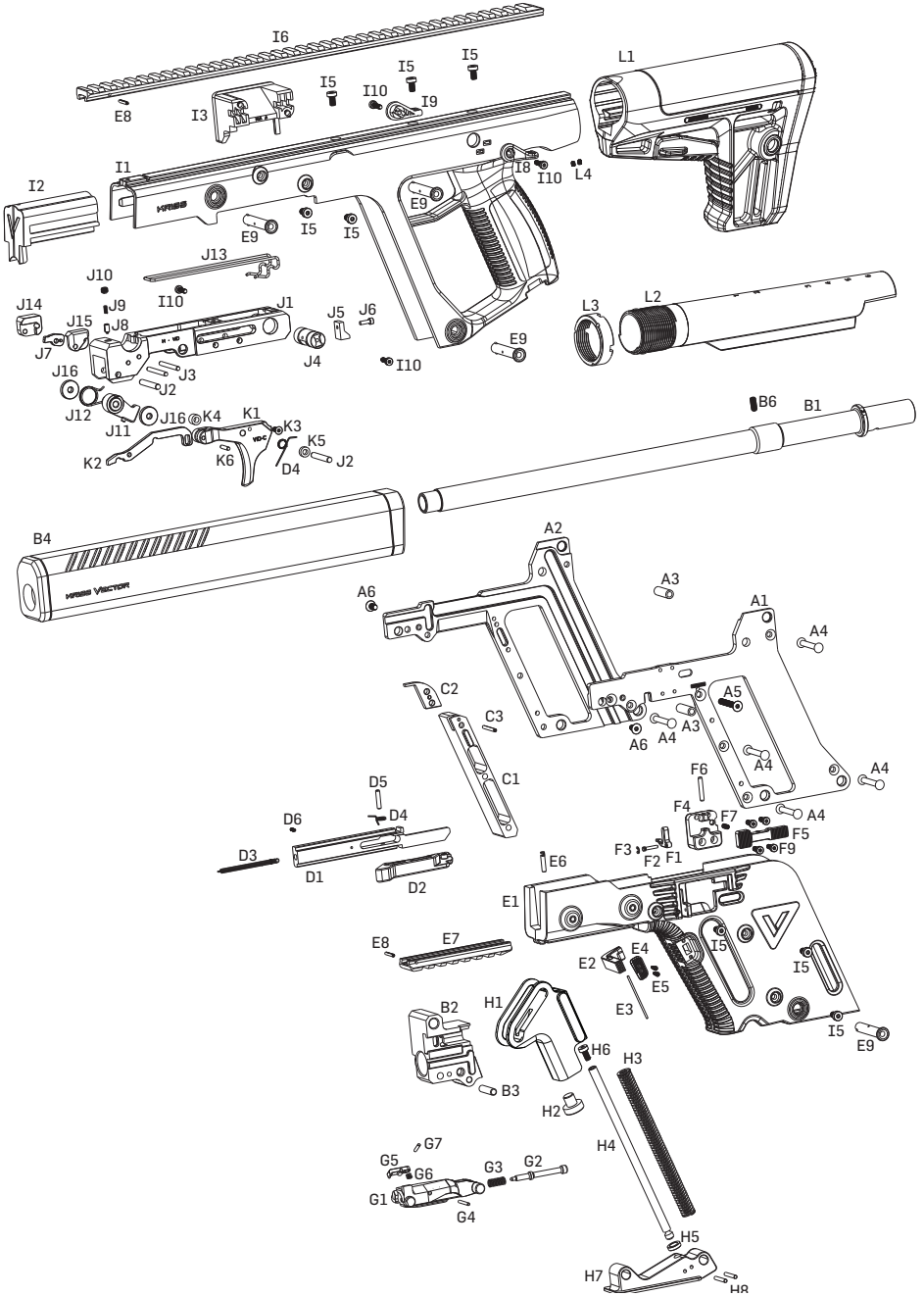



# COMPONENTS LIST : VECTOR CRB

A1	LH Receiver Plate Semi	F3	E-Clip	J3	Small Dowel Pin
A2	RH Receiver Plate Semi	F4	Bolt Catch Block	J4	Safety Cam
A3	Receiver Plate Spacer	F5	Bolt Lock	J5	Safety Stop Bar
A4	Receiver Plate Rivet	F6	Bolt Lock Pin	J6	Safety Stop Bar Screw
A5	Receiver Plate Screw	F7	Bolt Lock Spring	J7	Semi Disconnect
A6	Short Receiver Screw	F9	Bolt Lock Screw	J8	Plunger
B1*	Barrel	G1*	Bolt	J9	Semi Plunger Spring
B2	Trunnion	G2*	Firing Pin	J10	Plunger Set Screw
B3	Barrel Pin	G3	Firing Pin Spring	J11	Hammer Semi
B4*	Enhanced Shroud	G4	Firing pin Retaining Pin	J12	Hammer Spring
B6	Barrel Shroud Set Screw	G5*	Extractor	J13	Primary Sear Spring
C1*	Ejector Mount	G6	Extractor Spring	J14	FCG Spacer LH
C2*	Ejector	G7	Extractor Pin	J15	FCG Spacer RH
C3	Ejector Pin	H1*	Slider	J16	Hammer Spacer
C3	Ejector Pin	H2	Buffer	K1	Pivoting Trigger
D1	Charging Slider	H3*	Main Spring	K2	Pivoting Primary Sear
D2	Charging Handle	H4	Main Guide Shaft	K3	Trigger Spring Stop Screw
D3	Charging Slider Spring	H5	Spring Washer	K4	Pivoting Trigger Spacer LH
D4	Charging Handle Spring	H6	Main Guide Shaft Screw	K5	Pivoting Trigger Spacer RH
D5	Charging Handle Pivot Pin	H7	Spring Plate	K6	Trigger Sear Connector Pin
D6	Charging Slider Spring Retainer	H8	Main Guide Rod Retainer Pin	L1	DEFIANCE® DS-150 Stock
E1*	Lower Housing	I1	Upper Housing	L2	Buffer Tube
E2	Magazine Catch	I2	Nose Piece	L3	Castle Nut
E3	Magazine Catch Spring	I3*	Ejection Port	L4	Locking Screw
E4	Magazine Catch Button	15	FCG Screw	<p><b>* These parts are available in the following caliber:</b></p> <p><b>- 45ACP</b></p> <p><b>- 9x19mm</b></p> <p><b>- 9x21mm</b></p> <p><b>- 10mm</b></p> <p><b>- 40S&amp;W</b></p> <p><b>- .357 SIG</b></p>	
E5	Magazine Catch Screw	16	Upper Picatinny Rail		
E6	Charging Handle Spring Post	18	Safety Lever LH		
E7	Lower Picatinny Rail	19	Safety Lever RH		
E9	Break Down Pin	110	Safety Lever Screw		
F1	Bolt Lock Trigger	J1	Fire Control Group Frame Semi		
F2	Bolt Lock Trigger Pin	J2	Large Dowel Pin		

# COMPONENTS DIAGRAM : VECTOR SBR

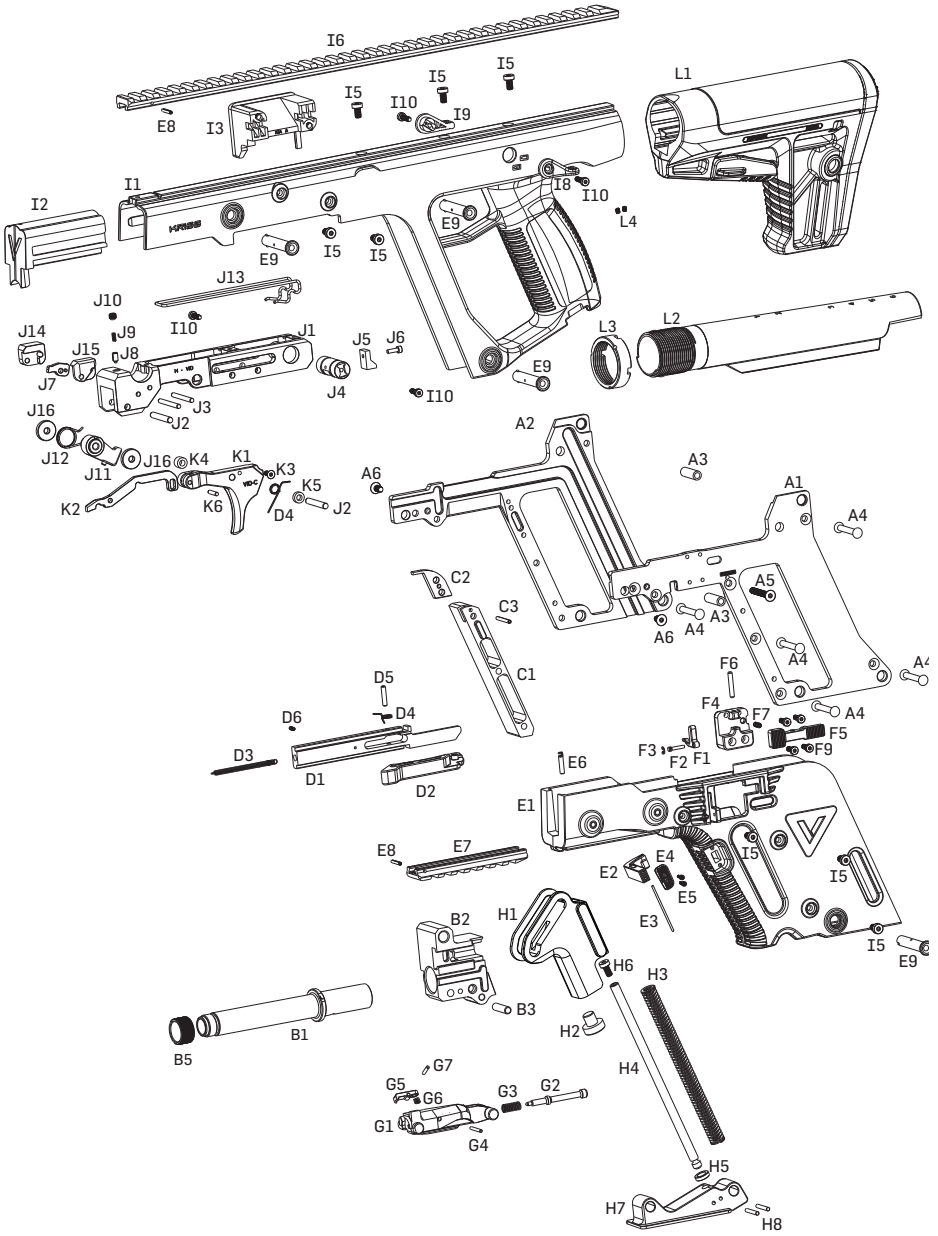

# COMPONENTS LIST : VECTOR SBR

A1	LH Receiver Plate Semi	F4	Bolt Catch Block	J3	Small Dowel Pin
A2	RH Receiver Plate Semi	F5	Bolt Lock	J4	Safety Cam
A3	Receiver Plate Spacer	F6	Bolt Lock Pin	J5	Safety Stop Bar
A4	Receiver Plate Rivet	F7	Bolt Lock Spring	J6	Safety Stop Bar Screw
A5	Receiver Plate Screw	F9	Bolt Lock Screw	J7	Semi Disconnect
A6	Short Receiver Screw	G1*	Bolt	J8	Plunger
B1*	Barrel	G2*	Firing Pin	J9	Semi Plunger Spring
B2	Trunnion	G3	Firing Pin Spring	J10	Plunger Set Screw
B3	Barrel Pin	G4	Firing pin Retaining Pin	J11	Hammer Semi
B5*	Thread Protector	G5*	Extractor	J12	Hammer Spring
C1*	Ejector Mount	G6	Extractor Spring	J13	Primary Sear Spring
C2*	Ejector	G7	Extractor Pin	J14	FCG Spacer LH
C3	Ejector Pin	H1*	Slider	J15	FCG Spacer RH
D1	Charging Slider	H2	Buffer	J16	Hammer Spacer
D2	Charging Handle	H3*	Main Spring	K1	Pivoting Trigger
D3	Charging Slider Spring	H4	Main Guide Shaft	K2	Pivoting Primary Sear
D4	Charging Handle Spring	H5	Spring Washer	K3	Trigger Spring Stop Screw
D5	Charging Handle Pivot Pin	H6	Main Guide Shaft Screw	K4	Pivoting Trigger Spacer LH
D6	Charging Slider Spring Retainer	H7	Spring Plate	K5	Pivoting Trigger Spacer RH
E1*	Lower Housing	H8	Main Guide Rod Retainer Pin	K6	Trigger Sear Connector Pin
E2	Magazine Catch	I1	Upper Housing	L1	DEFIANCE® DS-150 Stock
E3	Magazine Catch Spring	I2	Nose Piece	L2	Buffer Tube
E4	Magazine Catch Button	I3*	Ejection Port	L3	Castle Nut
E5	Magazine Catch Screw	I5	FCG Screw	L4	Locking Screw
E6	Charging Handle Spring Post	I6	Upper Picatinny Rail		
E7	Lower Picatinny Rail	18	Safety Lever LH		
E9	Break Down Pin	19	Safety Lever RH		
F1	Bolt Lock Trigger	I10	Safety Lever Screw		
F2	Bolt Lock Trigger Pin	J1	Fire Control Group Frame Semi		
F3	E-Clip	J2	Large Dowel Pin		

\* These parts are available in the following caliber:

- 45ACP

- 9x19mm

- 9x21mm

- 10mm

- 40S&W

- .357 SIG

# COMPONENTS DIAGRAM : VECTOR SDP

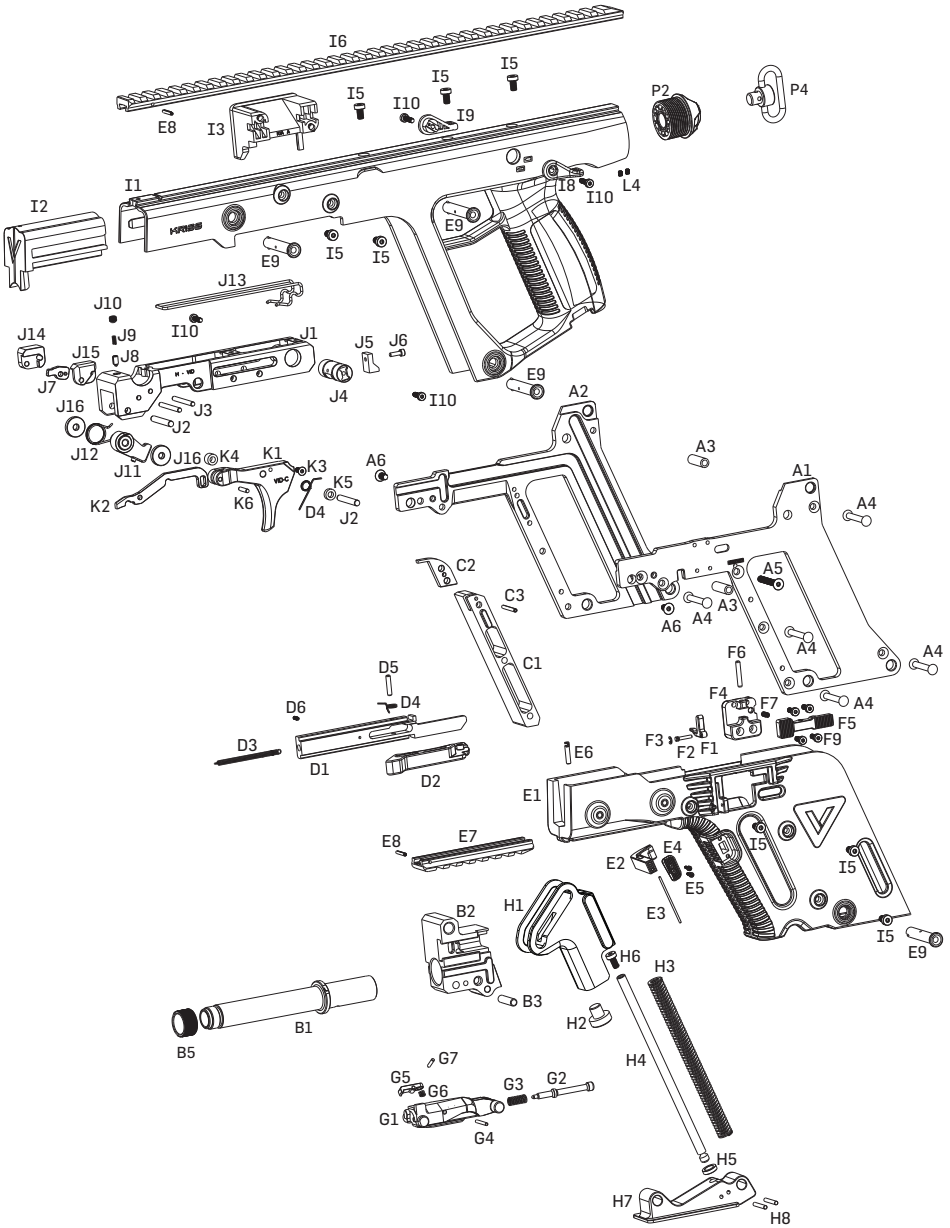

# COMPONENTS LIST : VECTOR SDP

A1	LH Receiver Plate Semi	F4	Bolt Catch Block	J3	Small Dowel Pin
A2	RH Receiver Plate Semi	F5	Bolt Lock	J4	Safety Cam
A3	Receiver Plate Spacer	F6	Bolt Lock Pin	J5	Safety Stop Bar
A4	Receiver Plate Rivet	F7	Bolt Lock Spring	J6	Safety Stop Bar Screw
A5	Receiver Plate Screw	F9	Bolt Lock Screw	J7	Semi Disconnect
A6	Short Receiver Screw	G1*	Bolt	J8	Plunger
B1*	Barrel	G2*	Firing Pin	J9	Semi Plunger Spring
B2	Trunnion	G3	Firing Pin Spring	J10	Plunger Set Screw
B3	Barrel Pin	G4	Firing pin Retaining Pin	J11	Hammer Semi
B5*	Thread Protector	G5*	Extractor	J12	Hammer Spring
C1*	Ejector Mount	G6	Extractor Spring	J13	Primary Sear Spring
C2*	Ejector	G7	Extractor Pin	J14	FCG Spacer LH
C3	Ejector Pin	H1*	Slider	J15	FCG Spacer RH
D1	Charging Slider	H2	Buffer	J16	Hammer Spacer
D2	Charging Handle	H3*	Main Spring	K1	Pivoting Trigger
D3	Charging Slider Spring	H4	Main Guide Shaft	K2	Pivoting Primary Sear
D4	Charging Handle Spring	H5	Spring Washer	K3	Trigger Spring Stop Screw
D5	Charging Handle Pivot Pin	H6	Main Guide Shaft Screw	K4	Pivoting Trigger Spacer LH
D6	Charging Slider Spring Retainer	H7	Spring Plate	K5	Pivoting Trigger Spacer RH
E1*	Lower Housing	H8	Main Guide Rod Retainer Pin	K6	Trigger Sear Connector Pin
E2	Magazine Catch	I1	Upper Housing	L4	Locking Screw
E3	Magazine Catch Spring	I2	Nose Piece	P2	Pistol Butt End
E4	Magazine Catch Button	I3*	Ejection Port	P4	QD Sling Swivel
E5	Magazine Catch Screw	15	FCG Screw		
E6	Charging Handle Spring Post	16	Upper Picatinny Rail		
E7	Lower Picatinny Rail	18	Safety Lever LH		
E9	Break Down Pin	19	Safety Lever RH		
F1	Bolt Lock Trigger	I10	Safety Lever Screw		
F2	Bolt Lock Trigger Pin	J1	Fire Control Group Frame Semi		
F3	E-Clip	J2	Large Dowel Pin		

\* These parts are available in the following caliber:

- 45ACP

- 9x19mm

- 9x21mm

- 10mm

- 40S&W

- .357 SIG

# COMPONENTS DIAGRAM : VECTOR SDP SB

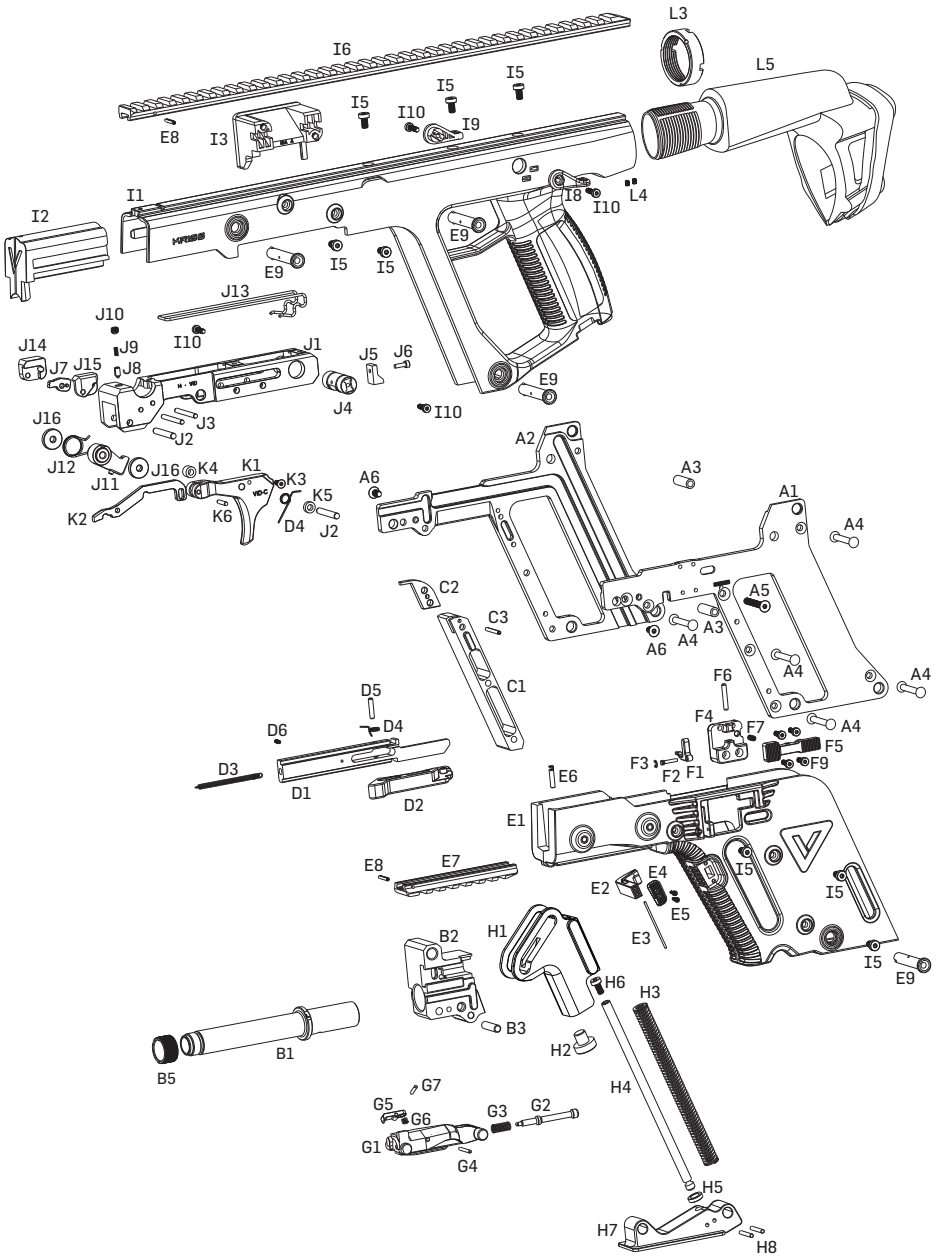

# COMPONENTS LIST : VECTOR SDP SB

A1	LH Receiver Plate Semi	F4	Bolt Catch Block	J3	Small Dowel Pin
A2	RH Receiver Plate Semi	F5	Bolt Lock	J4	Safety Cam
A3	Receiver Plate Spacer	F6	Bolt Lock Pin	J5	Safety Stop Bar
A4	Receiver Plate Rivet	F7	Bolt Lock Spring	J6	Safety Stop Bar Screw
A5	Receiver Plate Screw	F9	Bolt Lock Screw	J7	Semi Disconnect
A6	Short Receiver Screw	G1*	Bolt	J8	Plunger
B1*	Barrel	G2*	Firing Pin	J9	Semi Plunger Spring
B2	Trunnion	G3	Firing Pin Spring	J10	Plunger Set Screw
B3	Barrel Pin	G4	Firing pin Retaining Pin	J11	Hammer Semi
B5*	Thread Protector	G5*	Extractor	J12	Hammer Spring
C1*	Ejector Mount	G6	Extractor Spring	J13	Primary Sear Spring
C2*	Ejector	G7	Extractor Pin	J14	FCG Spacer LH
C3	Ejector Pin	H1*	Slider	J15	FCG Spacer RH
D1	Charging Slider	H2	Buffer	J16	Hammer Spacer
D2	Charging Handle	H3*	Main Spring	K1	Pivoting Trigger
D3	Charging Slider Spring	H4	Main Guide Shaft	K2	Pivoting Primary Sear
D4	Charging Handle Spring	H5	Spring Washer	K3	Trigger Spring Stop Screw
D5	Charging Handle Pivot Pin	H6	Main Guide Shaft Screw	K4	Pivoting Trigger Spacer LH
D6	Charging Slider Spring Retainer	H7	Spring Plate	K5	Pivoting Trigger Spacer RH
E1*	Lower Housing	H8	Main Guide Rod Retainer Pin	K6	Trigger Sear Connector Pin
E2	Magazine Catch	I1	Upper Housing	L3	Castle Nut
E3	Magazine Catch Spring	I2	Nose Piece	L4	Locking Screw
E4	Magazine Catch Button	I3*	Ejection Port	L5	Stablizing Brace
E5	Magazine Catch Screw	15	FCG Screw		
E6	Charging Handle Spring Post	16	Upper Picatinny Rail		
E7	Lower Picatinny Rail	18	Safety Lever LH		
E9	Break Down Pin	19	Safety Lever RH		
F1	Bolt Lock Trigger	I10	Safety Lever Screw		
F2	Bolt Lock Trigger Pin	J1	Fire Control Group Frame Semi		
F3	E-Clip	J2	Large Dowel Pin		

\* These parts are available in the following caliber:

- 45ACP

- 9x19mm

- 9x21mm

- 10mm

- 40S&W

- .357 SIG

